

JVC

SERVICE MANUAL

REAR PROJECTION TELEVISION

AV-48WP74/AHA, AV-56WP74/AHA

BASIC CHASSIS
SB3

Supplementary

The following items for the AV-48WP74/AHA and AV-56WP74/AHA model were changed partly from AV-48WP74/HA and AV-56WP74/HA model.

Therefore, this service manual describes only the items which differ from those of the AV-48WP74/HA and AV-56WP74/HA model service manual.

For details other than those described in this manual, please refer to the AV-48WP74/HA and AV-56WP74/HA model service manual (No.52105, 2003/04).

OUTLINE

Since the mirror was changed, we have issued the SERVICE MANUAL for AV-48WP74/AHA and AV-56WP74/AHA.

HOW TO IDENTIFY MODELS

A suffix "AHA" is added to the serial No. after at the rating label.

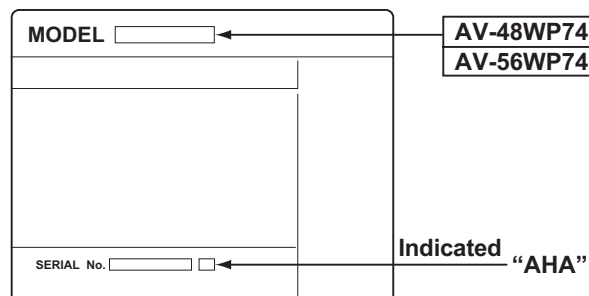

DIFFERENCE LIST

EXPLODED VIEW PARTS LIST -1 (Page 3-2)

△	Ref. No.	PARTS No.		PARTS NAME	DESCRIPTION
		AV-48WP74/HA	AV-48WP74/AHA		
	4	QYSBSF4012Z	-----	TAP SCREW (X2)	Delete
	5	LC31752-001A-A	-----	MIRROR BRACKET (X2)	Delete
	23	LC31733-001A-A	LC32173-003A-A	MIRROR	Glass
	70	-----	QYSBSF4012Z	TAP SCREW (X13)	Addition
	71	-----	LC21316-001A-A	MIRROR HOLDER TOP	Addition
	72	-----	LC21317-001A-A	MIRROR HOLDER BOTTOM	Addition
	73	-----	LC21311-001B-A	MIRROR HOLDER LEFT	Addition
	74	-----	LC21311-002B-A	MIRROR HOLDER RIGHT	Addition

△	Ref. No.	PARTS No.		PARTS NAME	DESCRIPTION
		AV-56WP74/HA	AV-56WP74/AHA		
	4	QYSBSF4012Z	-----	TAP SCREW (X2)	Delete
	5	LC41419-001A-A	-----	MIRROR BRACKET (X2)	Delete
	6	QYSBSF4012Z	-----	TAP SCREW (X2)	Delete
	23	LC31954-001A-A	LC32173-002A-A	MIRROR	Glass
	70	-----	QYSBSF4012Z	TAP SCREW (X13)	Addition
	71	-----	LC21316-001A-A	MIRROR HOLDER TOP	Addition
	72	-----	LC21317-001A-A	MIRROR HOLDER BOTTOM	Addition
	73	-----	LC21311-001B-A	MIRROR HOLDER LEFT	Addition
	74	-----	LC21311-002B-A	MIRROR HOLDER RIGHT	Addition

EXPLODED VIEW -1

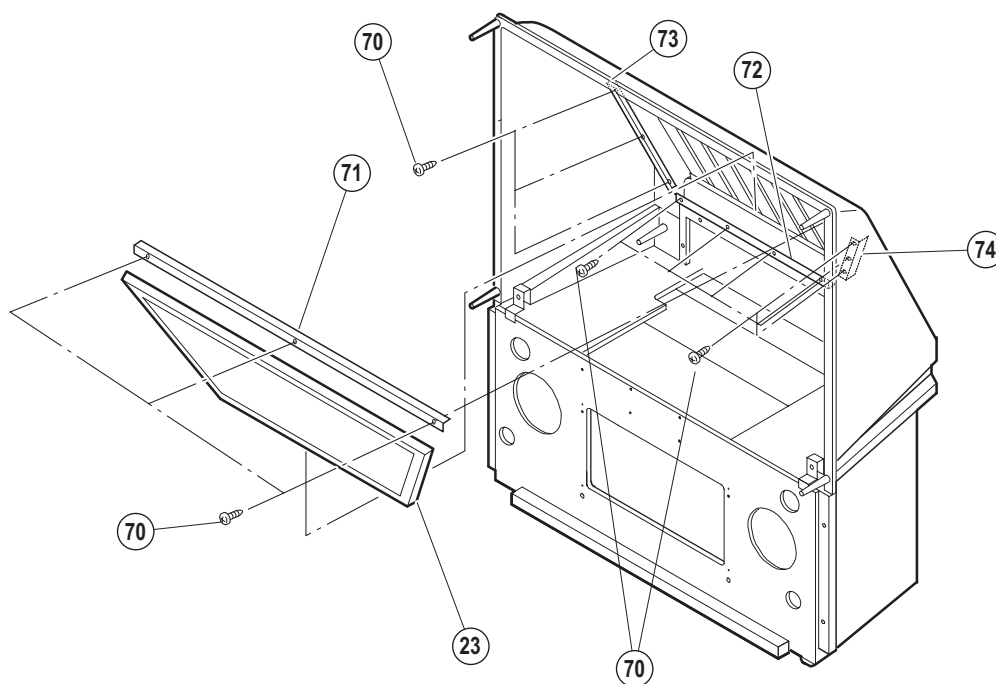

JVC

VICTOR COMPANY OF JAPAN, LIMITED

AV & MULTIMEDIA COMPANY VIDEO DISPLAY CATEGORY 12, 3-chome, Moriya-cho, kanagawa-ku, Yokohama, kanagawa-prefecture, 221-8528, Japan

(No.52105B)



Printed in Japan
WPC