

PARTS LIST

CAUTION

- The parts identified by the  symbol are important for the safety. Whenever replacing these parts, be sure to use specified ones to secure the safety .
- The parts not indicated in this Parts List and those which are filled with lines — in the Parts No. columns will not be supplied.
- P. W. Board Ass'y will not be supplied, but those which are filled with the Parts No. in the Parts No. columns will be supplied.

ABBREVIATIONS OF RESISTORS, CAPACITORS AND TOLERANCES

RESISTORS		CAPACITORS	
C R	Carbon Resistor	C CAP.	Ceramic Capacitor
F R	Fusible Resistor	E CAP.	Electrolytic Capacitor
P R	Plate Resistor	M CAP.	Mylar Capacitor
V R	Variable Resistor	HV CAP.	High Voltage Capacitor
HV R	High Voltage Resistor	MF CAP.	Metalized Film Capacitor
MF R	Metal Film Resistor	MM CAP.	Metalized Mylar Capacitor
MG R	Metal Glazed Resistor	MP CAP.	Metalized Polystyrol Capacitor
MP R	Metal Plate Resistor	PP CAP.	Polypropylene Capacitor
OM R	Metal Oxide Film Resistor	PS CAP.	Polystyrol Capacitor
CMF R	Coating Metal Film Resistor	TF CAP.	Thin Film Capacitor
UNF R	Non-Flammable Resistor	MPP CAP.	Metalized Polypropylene Capacitor
CH V R	Chip Variable Resistor	TAN. CAP.	Tantalum Capacitor
CH MG R	Chip Metal Glazed Resistor	CH C CAP.	Chip Ceramic Capacitor
COMP. R	Composition Resistor	BP E CAP.	Bi-Polar Electrolytic Capacitor
LPTC R	Linear Positive Temperature Coefficient Resistor	CH AL E CAP.	Chip Aluminum Electrolytic Capacitor
		CH AL BP CAP.	Chip Aluminum Bi-Polar Capacitor
		CH TAN. E CAP.	Chip Tantalum Electrolytic Capacitor
		CH AL BP E CAP.	Chip Tantalum Bi-Polar Electrolytic Capacitor

TOLERANCES									
F	G	J	K	M	N	R	H	Z	P
±1%	±2%	±5%	±10%	±20%	±30%	+30% -10%	+50% -10%	+80% -20%	+100% -0%

CONTENTS

■ USING PW BOARD & REMOTE CONTROL UNIT	55
■ EXPLODED VIEW PARTS LIST	56, 58
■ EXPLODED VIEW	56, 57, 58
■ PRINTED WIRING BOARD PARTS LIST	
● MAIN PW BOARD ASS'Y	59
● POWER & DEF. PW BOARD ASS'Y	65
● R CRT SOCKET PW BOARD ASS'Y	67
● G CRT SOCKET PW BOARD ASS'Y	67
● B CRT SOCKET PW BOARD ASS'Y	68
● CONVERGENCE PW BOARD ASS'Y	68
● R VM PW BOARD ASS'Y	69
● G VM PW BOARD ASS'Y	69
● B VM PW BOARD ASS'Y	70
● CENTER SPEAKER PW BOARD ASS'Y	70
● LINE FILTER PW BOARD ASS'Y	70
● REMOCON SENSOR PW BOARD ASS'Y	70
● DEF. OSC. PW BOARD ASS'Y	71
● AV JACK PW BOARD ASS'Y	72
● FRONT CONTROL PW BOARD ASS'Y	73
● RECEIVER PW BOARD ASS'Y	73
● CONVERGENCE OSD PW BOARD ASS'Y	74
● DIGITAL INPUT MODULE PW BOARD ASS'Y	74
● I-P CONVERT MODULE PW BOARD ASS'Y	74
■ REMOTE CONTROL UNIT PARTS LIST	75
■ PACKING	75
■ PACKING PARTS LIST	75

USING PW BOARD & REMOTE CONTROL UNIT

Δ	Model	AV-48WP30
	PWB ASS'Y	
	MAIN PWB ASSY	SSB-1051A-M2
	POWER&DEF. PWB ASSY	SSB-2051A-M2
	R CRT SOCKET PWB ASSY	SSB-3151A-M2
	G CRT SOCKET PWB ASSY	SSB-3251A-M2
	B CRT SOCKET PWB ASSY	SSB-3351A-M2
	CONVERGENCE PWB ASSY	SSB-5051A-M2
	R VM PWB ASSY	SSB-7151A-M2
	G VM PWB ASSY	SSB-7251A-M2
	B VM PWB ASSY	SSB-7351A-M2
	FRONT CONTROL PWB ASSY	SSB0L051A-M2
	FRONT I/F PWB ASSY	SSB0L251A-M2
	RECEIVER PWB ASSY	SSB0R251A-M2
	CENTER SPEAKER PWB ASSY	SSB0A051A-M2
	AV JACK PWB ASSY	SSB0J051A-M2
	LINE FILTER PWB ASSY	SSB-9051A-M2
	DEF. OSC. PWB ASSY	SSB0H051A-M2
	CONVERGENCE OSD PWB ASSY	SSB0T051A-M2
	REMOCON SENSOR PWB ASSY	SSB-8051A-M2
	DIGITAL INPUT MODULE PWB	SSB-7851A-M2
	I-P CONVERT MODULE PWB	SSB0D051A-M2
	REMOTE CONTROL UNIT	RM-C322G-1A

EXPLODED VIEW PARTS LIST (I)

△ Ref.No.	Part No.	Part Name	Description
1	QYSBSFG4016M	TAPPING SCREW	(x 19)
3	QYSBSAG4018M	TAPPING SCREW	(x 8)
4	LC31749-001A-A	LED LENS	
5	LC31751-001A-A	KNOB	
6	QYSBSF3012M	TAPPING SCREW	(x 2)
7	CM47752-006	BRAND MARK	
8	QYNSS3000P	PUSH NUT	
9	LC31733-001A-A	MIRROR	
△ 10	LC11247-001C-A	BACK COVER	
11	LC40690-001A	CLAMP	(x 2)
△ 12	LC31139-001A-A	RATING LABEL	
13	LC41237-001A	RUBBER CATCH	(x 4)
14	QAS0104-001	SPEAKER	(x 2) SP01-02
15	QAS0105-001	SPEAKER	(x 2) SP03-04
16	LC31757-001B-A	FRONT BOARD	
17	LC20981-001B-A	SHADING BOARD	
18	LC11251-001B-A	SPEAKER GRILL	
19	QYSBSFG4020M	TAPPING SCREW	(x 4)
△ 20	LC20982-001A-A	BACK BOARD	
△ 100	LC31883-001B-A	CONTROL ASSY	I nc. No. 101~102
△ 101	LC31829-001C-A	DOOR	
△ 102	PU60109	CATCHER	
△ 200	48WP30-SC-SA	SCREEN ASSY	I nc. No. 201 (SERVICE)
△ 201	LC11245-001C-A	FRONT PANEL	
△ 300	LC11248-001A-A	BODY	I nc. No. 301
301	CM36396-00B-A	CASTER	(x 4)

EXPLODED VIEW (I)

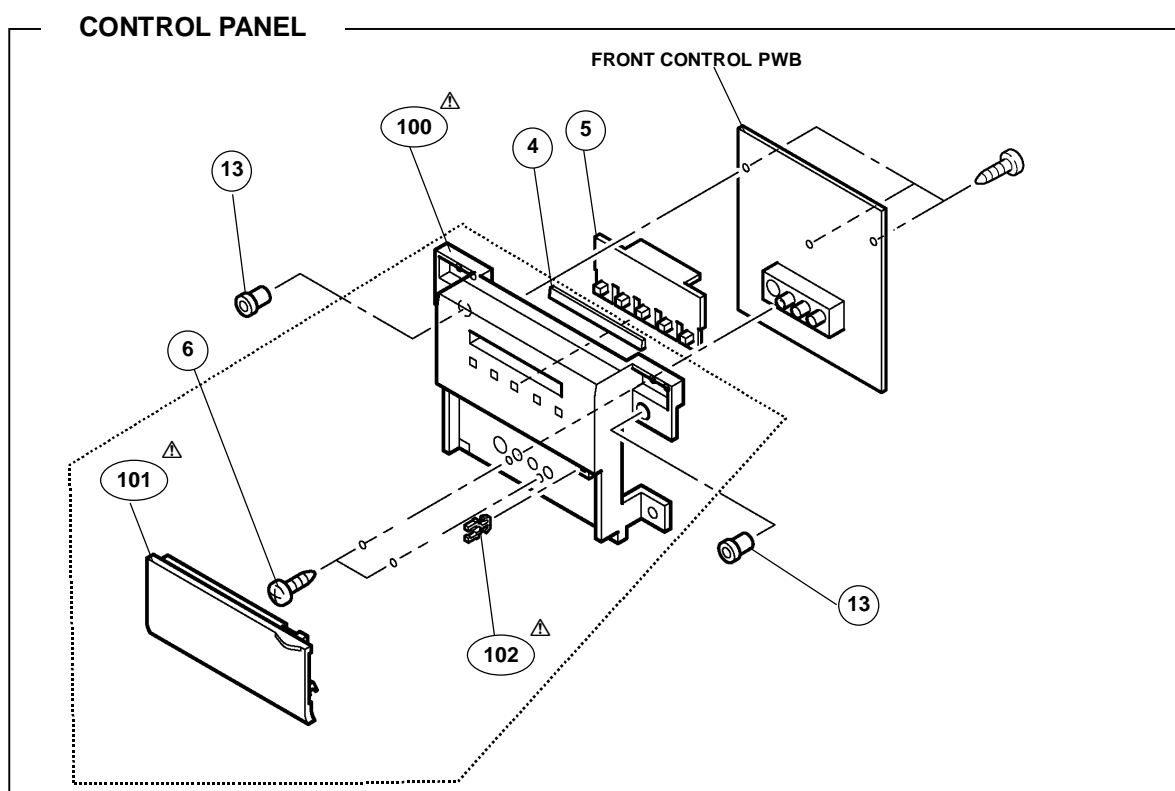

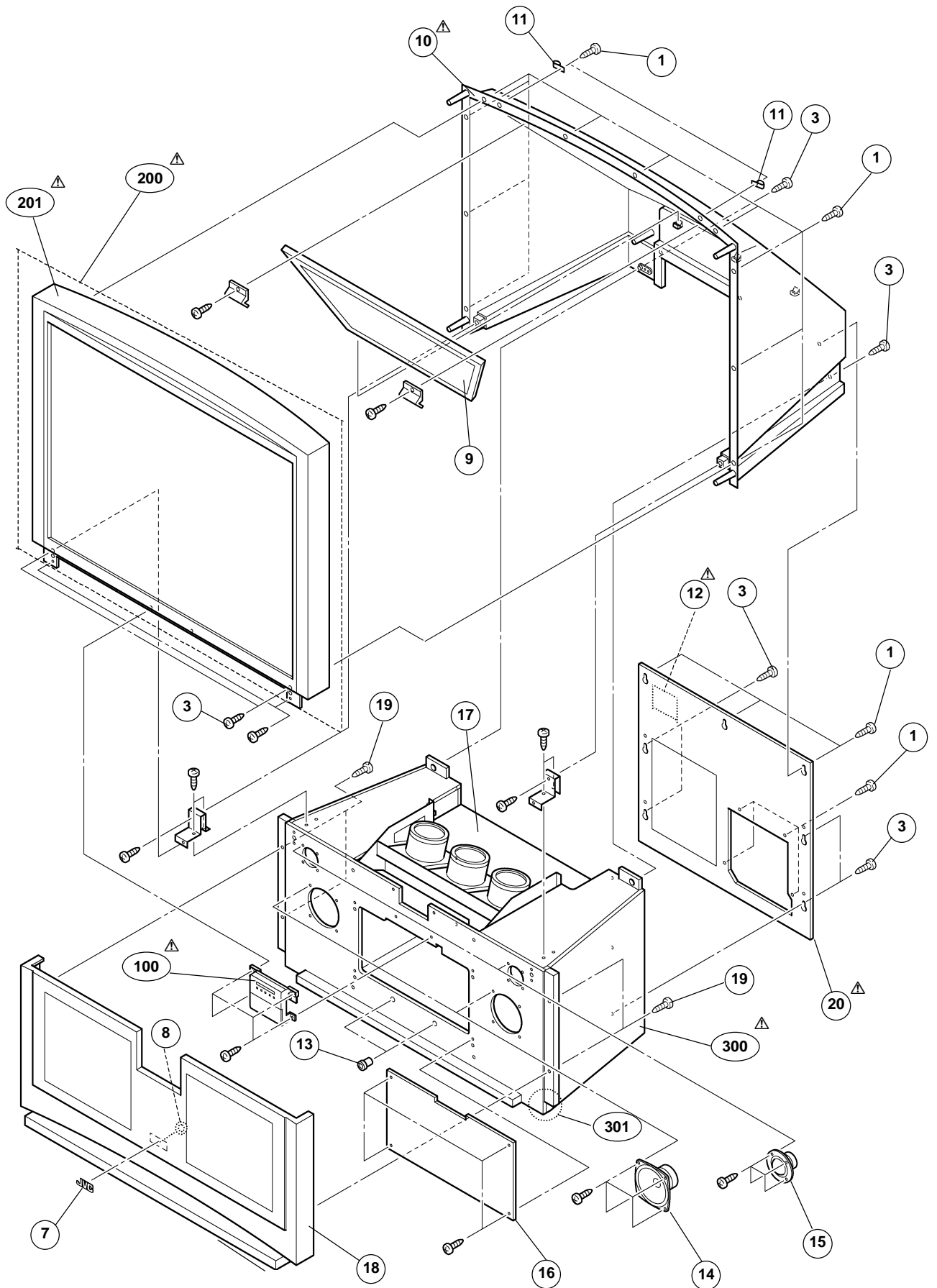

EXPLODED VIEW PARTS LIST (Ⅱ)

△ Ref.No.	Part No.	Part Name	Description
25	LC31735-001A-A	PJ LENS D250	(x 3)
△ 26	R CRT SA-M2	R CRT ASSY	
△ 27	G CRT SA-M2	G CRT ASSY	
△ 28	B CRT SA-M2	B CRT ASSY	
△ 29	QQD0069-001	DEF YOKE	(x 3)
30	QAL0398-001	PC MAGNET	(x 3)
△ 31	QAE0006-001	FOCUS PACK	
△ 32	QAE0005-001	HV DIVIDER	
△ 33	QNZ0563-001	ANODE WIRE ASSY	
△ 34	LC11249-001A-A	CHASSIS BASE	
△ 35	LC11250-001B-A	AV BOARD	
36	QYSBSF3012M	TAPPING SCREW	(x 7)
37	CHFD125-06BD	FFC WIRE	(x 2)
38	WJX0014-001A	E-COAXIAL	
△ 39	QMPD200-200-JC	POWER CORD	
△ 40	LC20106-001D-A	CORD CLAMP	
△ T2502	QQH0113-001	FBT	

EXPLODED VIEW (Ⅱ)

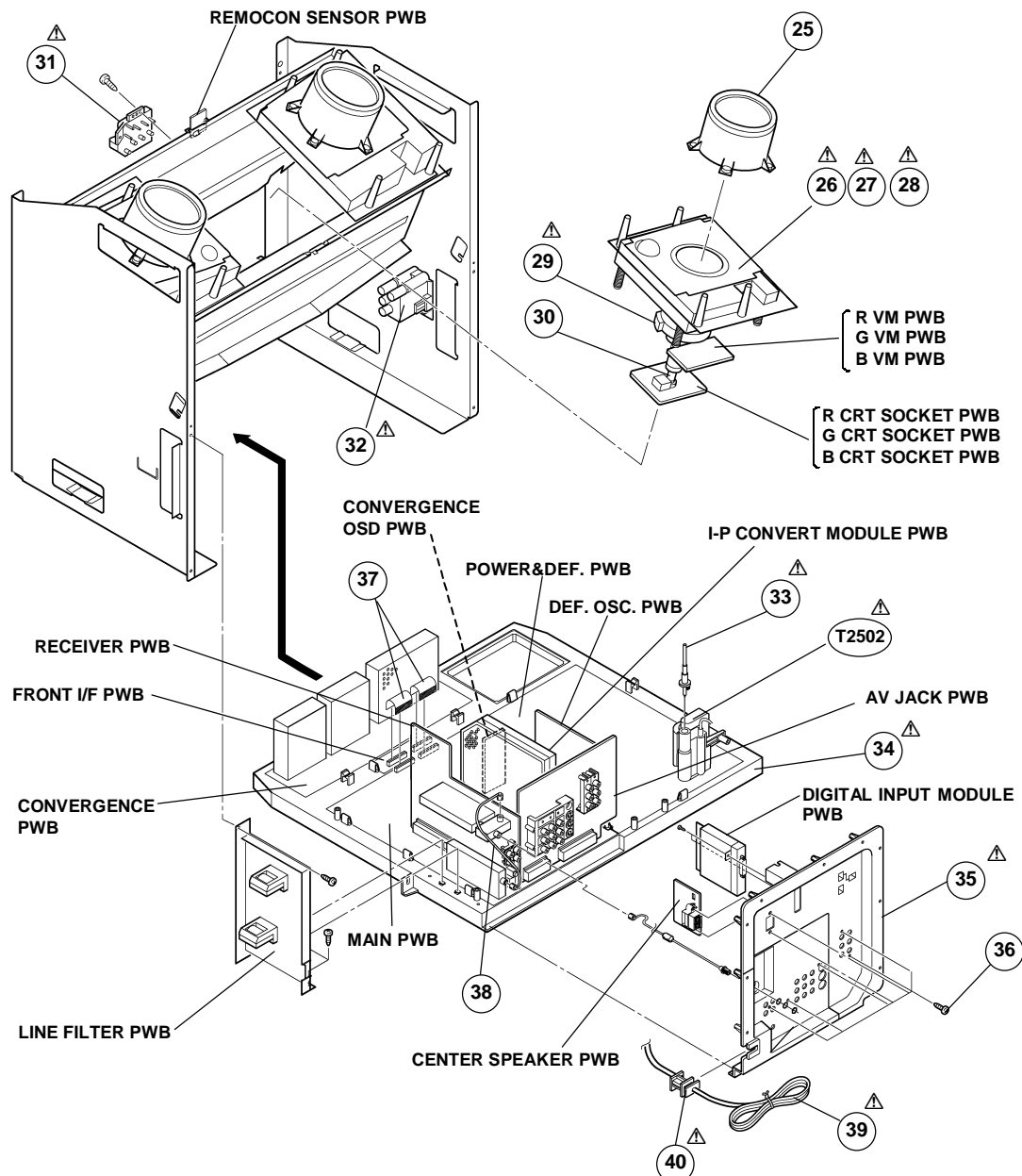

PRINTED WIRING BOARD PARTS LIST

MAIN P.W. BOARD ASS'Y (SSB-1051A-M2)

△ Symbol No.	Part No.	Part Name	Description	△ Symbol No.	Part No.	Part Name	Description
RESISTOR				RESISTOR			
R1001	NRSA63J-222X	MG R	2.2kΩ 1/16W J	R1253	NRSA63J-102X	MG R	1kΩ 1/16W J
R1004	NRSA63J-332X	MG R	3.3kΩ 1/16W J	R1254	NRSA63J-393X	MG R	39kΩ 1/16W J
R1005-06	NRSA63J-473X	MG R	47kΩ 1/16W J	R1258	NRSA63J-102X	MG R	1kΩ 1/16W J
R1007	NRSA63J-152X	MG R	1.5kΩ 1/16W J	R1260	NRSA63J-102X	MG R	1kΩ 1/16W J
R1011	NRSA63J-102X	MG R	1kΩ 1/16W J	R1264	NRSA63J-152X	MG R	1.5kΩ 1/16W J
R1013	NRSA63J-101X	MG R	100Ω 1/16W J	R1265	NRSA63J-153X	MG R	15kΩ 1/16W J
R1014	NRSA63J-223X	MG R	22kΩ 1/16W J	R1268	NRSA63J-272X	MG R	2.7kΩ 1/16W J
R1020	NRSA63J-473X	MG R	47kΩ 1/16W J	R1269	NRSA63J-332X	MG R	3.3kΩ 1/16W J
R1021	NRSA63J-103X	MG R	10kΩ 1/16W J	R1270	NRSA63J-222X	MG R	2.2kΩ 1/16W J
R1022-23	NRSA63J-101X	MG R	100Ω 1/16W J	R1271	NRSA63J-332X	MG R	3.3kΩ 1/16W J
R1024	NRSA63J-391X	MG R	390Ω 1/16W J	R1272-73	NRSA63J-101X	MG R	100Ω 1/16W J
R1025	NRSA63J-182X	MG R	1.8kΩ 1/16W J	R1274	NRSA02J-394X	MG R	390kΩ 1/10W J
R1050-52	NRSA63J-0R0X	MG R	0.0Ω 1/16W J	R1275-76	NRSA63J-101X	MG R	100Ω 1/16W J
R1101	NRSA63J-473X	MG R	47kΩ 1/16W J	R1278	NRSA63J-471X	MG R	470Ω 1/16W J
R1102-04	NRSA63J-0R0X	MG R	0.0Ω 1/16W J	R1279	NRSA63J-331X	MG R	330Ω 1/16W J
R1117	QRN143J-0R0X	C R	0.0Ω 1/4W J	R1280	NRSA63J-101X	MG R	100Ω 1/16W J
R1122	NRSA63J-0R0X	MG R	0.0Ω 1/16W J	R1282	NRVA63D-103X	MF R	10kΩ 1/16W±0.5%
R1131	NRSA63J-0R0X	MG R	0.0Ω 1/16W J	R1283	NRSA63J-682X	MG R	6.8kΩ 1/16W J
R1133	NRSA63J-121X	MG R	120Ω 1/16W J	R1284	NRSA63J-391X	MG R	390Ω 1/16W J
R1134	NRSA63J-0R0X	MG R	0.0Ω 1/16W J	R1301	NRSA63J-0R0X	MG R	0.0Ω 1/16W J
R1135	NRSA63J-121X	MG R	120Ω 1/16W J	R1302	NRSA63J-472X	MG R	4.7kΩ 1/16W J
R1136	NRSA63J-0R0X	MG R	0.0Ω 1/16W J	R1303	NRSA63J-392X	MG R	3.9kΩ 1/16W J
R1137	NRSA63J-121X	MG R	120Ω 1/16W J	R1304	NRSA63J-101X	MG R	100Ω 1/16W J
R1140-41	NRSA63J-222X	MG R	2.2kΩ 1/16W J	R1306	NRSA63J-105X	MG R	1MΩ 1/16W J
R1143	NRSA63J-101X	MG R	100Ω 1/16W J	R1307	NRSA63J-123X	MG R	12kΩ 1/16W J
R1144	NRSA63J-222X	MG R	2.2kΩ 1/16W J	R1308	NRSA63J-222X	MG R	2.2kΩ 1/16W J
R1145	NRSA63J-471X	MG R	470Ω 1/16W J	R1309	NRSA63J-124X	MG R	120kΩ 1/16W J
R1147	NRSA63J-681X	MG R	680Ω 1/16W J	R1310	NRSA63J-272X	MG R	2.7kΩ 1/16W J
R1149	NRSA63J-681X	MG R	680Ω 1/16W J	R1311-12	NRSA63J-101X	MG R	100Ω 1/16W J
R1153-54	NRSA63J-221X	MG R	220Ω 1/16W J	R1313	NRSA63J-222X	MG R	2.2kΩ 1/16W J
R1157	NRSA63J-470X	MG R	47Ω 1/16W J	R1314	NRSA63J-103X	MG R	10kΩ 1/16W J
R1158-59	NRSA63J-0R0X	MG R	0.0Ω 1/16W J	R1317	NRSA63J-0R0X	MG R	0.0Ω 1/16W J
R1161	NRSA63J-222X	MG R	2.2kΩ 1/16W J	R1318	NRSA63J-821X	MG R	820Ω 1/16W J
R1163-65	NRSA63J-224X	MG R	220kΩ 1/16W J	R1319-22	NRSA63J-222X	MG R	2.2kΩ 1/16W J
R1166	NRSA63J-471X	MG R	470Ω 1/16W J	R1323	NRSA63J-104X	MG R	100kΩ 1/16W J
R1167	NRSA63J-0R0X	MG R	0.0Ω 1/16W J	R1324-25	NRSA63J-221X	MG R	220Ω 1/16W J
R1174	NRSA63J-101X	MG R	100Ω 1/16W J	R1326	NRSA63J-0R0X	MG R	0.0Ω 1/16W J
R1175-77	NRSA63J-224X	MG R	220kΩ 1/16W J	R1327	NRSA63J-221X	MG R	220Ω 1/16W J
R1179	NRSA63J-0R0X	MG R	0.0Ω 1/16W J	R1328-29	NRSA63J-101X	MG R	100Ω 1/16W J
R1180-82	NRSA63J-221X	MG R	220Ω 1/16W J	R1330	NRSA63J-182X	MG R	1.8kΩ 1/16W J
R1183-86	NRSA63J-101X	MG R	100Ω 1/16W J	R1331	NRSA63J-223X	MG R	22kΩ 1/16W J
R1187-89	NRSA63J-224X	MG R	220kΩ 1/16W J	R1332	NRSA63J-182X	MG R	1.8kΩ 1/16W J
R1190	NRSA63J-101X	MG R	100Ω 1/16W J	R1333	NRSA63J-104X	MG R	100kΩ 1/16W J
R1198	NRSA63J-271X	MG R	270Ω 1/16W J	R1334-37	NRSA63J-151X	MG R	150Ω 1/16W J
R1199	NRVA63D-102X	MF R	1.0kΩ 1/16W±0.5%	R1338	NRSA63J-182X	MG R	1.8kΩ 1/16W J
R1202-03	NRSA63J-101X	MG R	100Ω 1/16W J	R1339	NRSA63J-104X	MG R	100kΩ 1/16W J
R1213-14	NRSA63J-101X	MG R	100Ω 1/16W J	R1340-41	NRSA63J-151X	MG R	150Ω 1/16W J
R1218	NRSA63J-822X	MG R	8.2kΩ 1/16W J	R1342	NRVA63D-102X	MF R	1.0kΩ 1/16W±0.5%
R1219	NRSA63J-331X	MG R	330Ω 1/16W J	R1343	NRVA63D-122X	MF R	1.2kΩ 1/16W±0.5%
R1220-21	NRSA63J-101X	MG R	100Ω 1/16W J	R1344-45	NRSA63J-471X	MG R	470Ω 1/16W J
R1224-25	NRSA63J-101X	MG R	100Ω 1/16W J	R1346-48	NRSA63J-680X	MG R	68Ω 1/16W J
R1226-27	NRSA63J-103X	MG R	10kΩ 1/16W J	R1349	NRSA63J-471X	MG R	470Ω 1/16W J
R1228	NRSA63J-222X	MG R	2.2kΩ 1/16W J	R1350	NRSA63J-563X	MG R	56kΩ 1/16W J
R1229	NRSA63J-103X	MG R	10kΩ 1/16W J	R1352	NRSA63J-103X	MG R	10kΩ 1/16W J
R1230	NRSA63J-101X	MG R	100Ω 1/16W J	R1353	NRSA63J-223X	MG R	22kΩ 1/16W J
R1231	NRSA63J-221X	MG R	220Ω 1/16W J	R1354	NRSA63J-471X	MG R	470Ω 1/16W J
R1232	NRSA63J-562X	MG R	5.6kΩ 1/16W J	R1355	NRSA63J-562X	MG R	5.6kΩ 1/16W J
R1234	NRSA63J-562X	MG R	5.6kΩ 1/16W J	R1359	NRSA63J-101X	MG R	100Ω 1/16W J
R1235	NRSA63J-221X	MG R	220Ω 1/16W J	R1363	NRSA63J-101X	MG R	100Ω 1/16W J
R1236	NRSA63J-562X	MG R	5.6kΩ 1/16W J	R1364	NRSA63J-102X	MG R	1kΩ 1/16W J
R1241-42	NRSA63J-0R0X	MG R	0.0Ω 1/16W J	R1365	NRSA63J-682X	MG R	6.8kΩ 1/16W J
R1250	NRSA63J-332X	MG R	3.3kΩ 1/16W J	R1366	NRSA63J-471X	MG R	470Ω 1/16W J
R1251	NRSA63J-101X	MG R	100Ω 1/16W J	R1367	NRSA63J-222X	MG R	2.2kΩ 1/16W J
R1252	NRSA63J-152X	MG R	1.5kΩ 1/16W J	R1368	NRSA63J-103X	MG R	10kΩ 1/16W J

△ Symbol No.	Part No.	Part Name	Description
RESISTOR			
R1369	NRSA63J-0R0X	MG R	0.0Ω 1/16W J
R1370	NRVA63D-182X	MF R	1.8kΩ 1/16W±0.5%
R1371	NRSA63J-222X	MG R	2.2kΩ 1/16W J
R1373	NRSA63J-332X	MG R	3.3kΩ 1/16W J
R1374	NRSA63J-472X	MG R	4.7kΩ 1/16W J
R1377	NRSA63J-103X	MG R	10kΩ 1/16W J
R1378	NRSA63J-152X	MG R	1.5kΩ 1/16W J
R1379	NRSA63J-102X	MG R	1kΩ 1/16W J
R1380	NRSA63J-562X	MG R	5.6kΩ 1/16W J
△ R1381	NRVA63D-472X	MF R	4.7kΩ 1/16W±0.5%
R1382	NRSA63J-151X	MG R	150Ω 1/16W J
R1383	NRVA63D-332X	MF R	3.3kΩ 1/16W±0.5%
△ R1384-86	NRSA63J-221X	MG R	220Ω 1/16W J
R1387	NRVA63D-472X	MF R	4.7kΩ 1/16W±0.5%
R1388	NRSA63J-471X	MG R	470Ω 1/16W J
R1389	NRVA63D-272X	MF R	2.7kΩ 1/16W±0.5%
R1390	NRSA63J-153X	MG R	15kΩ 1/16W J
R1391-92	NRSA63J-221X	MG R	220Ω 1/16W J
R1395	NRSA63J-102X	MG R	1kΩ 1/16W J
R1396	NRSA63J-561X	MG R	560Ω 1/16W J
R1397	NRSA63J-223X	MG R	22kΩ 1/16W J
R1399	NRSA63J-472X	MG R	4.7kΩ 1/16W J
R1401	NRSA63J-101X	MG R	100Ω 1/16W J
R1408	NRSA63J-0R0X	MG R	0.0Ω 1/16W J
R1415	NRSA63J-0R0X	MG R	0.0Ω 1/16W J
R1430	NRSA63J-101X	MG R	100Ω 1/16W J
R1432	NRSA63J-682X	MG R	6.8kΩ 1/16W J
R1434	NRSA63J-103X	MG R	10kΩ 1/16W J
R1435	NRSA63J-473X	MG R	47kΩ 1/16W J
R1441	NRSA63J-223X	MG R	22kΩ 1/16W J
R1442	NRSA63J-103X	MG R	10kΩ 1/16W J
R1450	NRSA63J-221X	MG R	220Ω 1/16W J
R1451	NRSA63J-182X	MG R	1.8kΩ 1/16W J
R1452	NRSA63J-101X	MG R	100Ω 1/16W J
R1453	NRSA63J-391X	MG R	390Ω 1/16W J
R1454	NRSA63J-561X	MG R	560Ω 1/16W J
R1455	NRSA63J-562X	MG R	5.6kΩ 1/16W J
R1456	NRSA63J-223X	MG R	22kΩ 1/16W J
R1463	NRSA63J-102X	MG R	1kΩ 1/16W J
R1464	NRSA63J-122X	MG R	1.2kΩ 1/16W J
R1465	NRSA63J-102X	MG R	1kΩ 1/16W J
R1467	NRSA63J-103X	MG R	10kΩ 1/16W J
R1468	NRSA63J-101X	MG R	100Ω 1/16W J
R1469	NRSA63J-472X	MG R	4.7kΩ 1/16W J
R1470	NRSA63J-563X	MG R	56kΩ 1/16W J
R1472	NRSA63J-101X	MG R	100Ω 1/16W J
R1473	NRSA63J-152X	MG R	1.5kΩ 1/16W J
R1474	NRSA63J-562X	MG R	5.6kΩ 1/16W J
R1475	NRSA63J-102X	MG R	1kΩ 1/16W J
R1477	NRSA63J-562X	MG R	5.6kΩ 1/16W J
R1478	NRSA63J-152X	MG R	1.5kΩ 1/16W J
R1479	NRSA63J-101X	MG R	100Ω 1/16W J
R1480	NRSA63J-223X	MG R	22kΩ 1/16W J
R1481	NRSA63J-101X	MG R	100Ω 1/16W J
R1482	NRSA63J-103X	MG R	10kΩ 1/16W J
R1483	NRSA63J-182X	MG R	1.8kΩ 1/16W J
R1484	NRSA63J-221X	MG R	220Ω 1/16W J
R1485	NRSA63J-391X	MG R	390Ω 1/16W J
R1486	NRSA63J-561X	MG R	560Ω 1/16W J
R1487	NRSA63J-562X	MG R	5.6kΩ 1/16W J
R1488	NRSA63J-223X	MG R	22kΩ 1/16W J
R1490	NRSA63J-102X	MG R	1kΩ 1/16W J
R1491	NRSA63J-122X	MG R	1.2kΩ 1/16W J
R1492-93	NRSA63J-102X	MG R	1kΩ 1/16W J

△ Symbol No.	Part No.	Part Name	Description
RESISTOR			
R1495	NRSA63J-103X	MG R	10kΩ 1/16W J
R1496	NRSA63J-101X	MG R	100Ω 1/16W J
R1497	NRSA63J-472X	MG R	4.7kΩ 1/16W J
R1498	NRSA63J-563X	MG R	56kΩ 1/16W J
R1501-02	NRSA63J-221X	MG R	220Ω 1/16W J
R1503	NRSA63J-103X	MG R	10kΩ 1/16W J
R1507-08	NRSA63J-101X	MG R	100Ω 1/16W J
R1514	NRSA63J-0R0X	MG R	0.0Ω 1/16W J
R1515	NRSA63J-221X	MG R	220Ω 1/16W J
R1516	NRSA63J-682X	MG R	6.8kΩ 1/16W J
R1517	NRSA63J-221X	MG R	220Ω 1/16W J
R1518	NRSA63J-682X	MG R	6.8kΩ 1/16W J
R1519	NRSA63J-221X	MG R	220Ω 1/16W J
R1521-22	NRSA63J-221X	MG R	220Ω 1/16W J
R1524	NRSA63J-221X	MG R	220Ω 1/16W J
R1526	NRSA63J-682X	MG R	6.8kΩ 1/16W J
R1527	NRSA63J-221X	MG R	220Ω 1/16W J
R1528	NRSA63J-682X	MG R	6.8kΩ 1/16W J
R1529	NRSA63J-221X	MG R	220Ω 1/16W J
R1530	NRSA63J-102X	MG R	1kΩ 1/16W J
R1531	NRSA63J-101X	MG R	100Ω 1/16W J
R1532	NRSA63J-0R0X	MG R	0.0Ω 1/16W J
R1533	NRSA63J-221X	MG R	220Ω 1/16W J
R1534	NRSA63J-682X	MG R	6.8kΩ 1/16W J
R1535	NRSA63J-221X	MG R	220Ω 1/16W J
R1536	NRSA63J-682X	MG R	6.8kΩ 1/16W J
R1537-38	NRSA63J-221X	MG R	220Ω 1/16W J
R1539	NRSA63J-682X	MG R	6.8kΩ 1/16W J
R1547	NRSA63J-682X	MG R	6.8kΩ 1/16W J
R1548	NRSA63J-0R0X	MG R	0.0Ω 1/16W J
R1549	NRSA63J-682X	MG R	6.8kΩ 1/16W J
R1551	NRSA63J-0R0X	MG R	0.0Ω 1/16W J
R1554	NRSA63J-0R0X	MG R	0.0Ω 1/16W J
R1555	NRSA63J-103X	MG R	10kΩ 1/16W J
R1556-57	NRSA63J-101X	MG R	100Ω 1/16W J
R1560	NRSA63J-102X	MG R	1kΩ 1/16W J
R1561-62	NRSA63J-101X	MG R	100Ω 1/16W J
R1570	NRSA63J-103X	MG R	10kΩ 1/16W J
R1571	NRVA63D-152X	MF R	1.5kΩ 1/16W±0.5%
R1572	NRSA02F-471X	MG R	470Ω 1/10W F
R1576	NRSA63J-273X	MG R	27kΩ 1/16W J
R1577	NRSA63J-221X	MG R	220Ω 1/16W J
R1578	NRSA63J-682X	MG R	6.8kΩ 1/16W J
R1579	NRSA63J-221X	MG R	220Ω 1/16W J
R1581	NRSA63J-101X	MG R	100Ω 1/16W J
R1586-89	NRSA63J-0R0X	MG R	0.0Ω 1/16W J
R1611-12	NRSA63J-563X	MG R	56kΩ 1/16W J
R1613	NRSA63J-102X	MG R	1kΩ 1/16W J
R1614	NRSA63J-104X	MG R	100kΩ 1/16W J
R1615	NRSA63J-563X	MG R	56kΩ 1/16W J
R1616	NRSA63J-153X	MG R	15kΩ 1/16W J
R1618-19	NRSA63J-0R0X	MG R	0.0Ω 1/16W J
R1634-35	NRSA63J-0R0X	MG R	0.0Ω 1/16W J
R1638-39	NRSA63J-0R0X	MG R	0.0Ω 1/16W J
R1644	NRSA63J-0R0X	MG R	0.0Ω 1/16W J
R1654-56	NRSA63J-0R0X	MG R	0.0Ω 1/16W J
R1658-59	NRSA63J-103X	MG R	10kΩ 1/16W J
R1661	NRSA63J-0R0X	MG R	0.0Ω 1/16W J
R1663	NRSA63J-0R0X	MG R	0.0Ω 1/16W J
R1665	NRSA63J-222X	MG R	2.2kΩ 1/16W J
R1666	NRSA63J-472X	MG R	4.7kΩ 1/16W J
R1667-68	NRSA63J-222X	MG R	2.2kΩ 1/16W J
R1669	NRSA63J-472X	MG R	4.7kΩ 1/16W J
R1670	NRSA63J-222X	MG R	2.2kΩ 1/16W J

△ Symbol No.	Part No.	Part Name	Description
RESISTOR			
△ R1671	QRJ146J-2R2X	C R	2.2Ω 1/4W J
△ R1672	QRJ146J-2R2X	C R	2.2Ω 1/4W J
△ R1673	QRK126J-102X	C R	1kΩ 1/2W J
△ R1674	QRK126J-102X	C R	1kΩ 1/2W J
R1680	NRSA63J-822X	MG R	8.2kΩ 1/16W J
R1681	NRSA63J-473X	MG R	47kΩ 1/16W J
R1682	NRSA63J-103X	MG R	10kΩ 1/16W J
R1691	NRSA63J-104X	MG R	100kΩ 1/16W J
R1701	NRSA63J-104X	MG R	100kΩ 1/16W J
R1702	NRSA63J-103X	MG R	10kΩ 1/16W J
R1703	NRSA63J-0R0X	MG R	0.0Ω 1/16W J
R1704	NRSA63J-221X	MG R	220Ω 1/16W J
R1706	NRSA63J-104X	MG R	100kΩ 1/16W J
R1707	NRSA63J-0R0X	MG R	0.0Ω 1/16W J
R1709-10	NRSA63J-104X	MG R	100kΩ 1/16W J
R1712	NRSA63J-0R0X	MG R	0.0Ω 1/16W J
R1714	NRSA63J-103X	MG R	10kΩ 1/16W J
R1715-16	NRSA63J-101X	MG R	100Ω 1/16W J
R1719	NRSA63J-0R0X	MG R	0.0Ω 1/16W J
R1721	NRSA63J-102X	MG R	1kΩ 1/16W J
R1722	NRSA63J-0R0X	MG R	0.0Ω 1/16W J
R1724	NRSA63J-103X	MG R	10kΩ 1/16W J
R1725-26	NRSA63J-0R0X	MG R	0.0Ω 1/16W J
R1727	NRSA63J-103X	MG R	10kΩ 1/16W J
R1728	NRSA63J-102X	MG R	1kΩ 1/16W J
R1729	NRSA63J-101X	MG R	100Ω 1/16W J
R1730	NRSA63J-272X	MG R	2.7kΩ 1/16W J
R1731	NRSA63J-101X	MG R	100Ω 1/16W J
R1732	NRSA63J-272X	MG R	2.7kΩ 1/16W J
R1733	NRSA63J-102X	MG R	1kΩ 1/16W J
R1735	NRSA63J-104X	MG R	100kΩ 1/16W J
R1736	NRSA63J-333X	MG R	33kΩ 1/16W J
R1737	NRSA63J-101X	MG R	100Ω 1/16W J
R1738	NRSA63J-333X	MG R	33kΩ 1/16W J
R1744	NRSA63J-472X	MG R	4.7kΩ 1/16W J
R1746	NRSA63J-332X	MG R	3.3kΩ 1/16W J
R1747	NRSA63J-0R0X	MG R	0.0Ω 1/16W J
R1748	NRSA63J-102X	MG R	1kΩ 1/16W J
R1749	NRSA63J-124X	MG R	120kΩ 1/16W J
R1750	NRSA63J-104X	MG R	100kΩ 1/16W J
R1751	NRSA63J-473X	MG R	47kΩ 1/16W J
R1752-53	NRSA63J-333X	MG R	33kΩ 1/16W J
R1754	NRSA63J-0R0X	MG R	0.0Ω 1/16W J
R1756	NRSA63J-103X	MG R	10kΩ 1/16W J
R1760	NRSA63J-0R0X	MG R	0.0Ω 1/16W J
R1761	NRSA63J-102X	MG R	1kΩ 1/16W J
R1762	NRSA63J-124X	MG R	120kΩ 1/16W J
R1763-64	NRSA63J-333X	MG R	33kΩ 1/16W J
R1765	NRSA63J-102X	MG R	1kΩ 1/16W J
R1766	NRSA63J-332X	MG R	3.3kΩ 1/16W J
R1767	NRSA63J-151X	MG R	150Ω 1/16W J
R1768	NRSA63J-101X	MG R	100Ω 1/16W J
R1770	NRSA63J-101X	MG R	100Ω 1/16W J
R1775	NRSA63J-332X	MG R	3.3kΩ 1/16W J
R1776	NRSA63J-333X	MG R	33kΩ 1/16W J
R1777-78	NRSA63J-103X	MG R	10kΩ 1/16W J
R1779	NRSA63J-102X	MG R	1kΩ 1/16W J
R1780	NRSA63J-103X	MG R	10kΩ 1/16W J
R1781	NRSA63J-333X	MG R	33kΩ 1/16W J
R1782	NRSA63J-122X	MG R	1.2kΩ 1/16W J
R1783	NRSA63J-101X	MG R	100Ω 1/16W J
R1784	NRSA63J-682X	MG R	6.8kΩ 1/16W J
R1785	NRSA63J-103X	MG R	10kΩ 1/16W J
R1787	NRSA63J-562X	MG R	5.6kΩ 1/16W J

△ Symbol No.	Part No.	Part Name	Description
RESISTOR			
R1788-90	NRSA63J-560X	MG R	56Ω 1/16W J
R1791	NRSA63J-101X	MG R	100Ω 1/16W J
R1792	NRSA63J-102X	MG R	1kΩ 1/16W J
R1793	NRSA63J-104X	MG R	100kΩ 1/16W J
R1794	NRSA63J-101X	MG R	100Ω 1/16W J
R1802	NRSA63J-104X	MG R	100kΩ 1/16W J
R1803	NRSA63J-473X	MG R	47kΩ 1/16W J
R1804	NRSA63J-101X	MG R	100Ω 1/16W J
R1806	NRSA63J-101X	MG R	100Ω 1/16W J
R1808	NRSA63J-151X	MG R	150Ω 1/16W J
R1811	NRSA63J-101X	MG R	100Ω 1/16W J
R1814	NRSA63J-102X	MG R	1kΩ 1/16W J
R1815-16	NRSA63J-0R0X	MG R	0.0Ω 1/16W J
R1817	NRSA63J-101X	MG R	100Ω 1/16W J
R1818	NRSA63J-0R0X	MG R	0.0Ω 1/16W J
R1820	NRSA63J-393X	MG R	39kΩ 1/16W J
R1822	NRSA63J-472X	MG R	4.7kΩ 1/16W J
R1823	NRSA63J-124X	MG R	120kΩ 1/16W J
R1829	NRSA63J-103X	MG R	10kΩ 1/16W J
R1830-31	NRSA63J-102X	MG R	1kΩ 1/16W J
R1832	NRSA63J-103X	MG R	10kΩ 1/16W J
R1834	NRSA63J-102X	MG R	1kΩ 1/16W J
R1836	NRSA63J-101X	MG R	100Ω 1/16W J
R1837	NRSA63J-333X	MG R	33kΩ 1/16W J
R1838	NRSA63J-101X	MG R	100Ω 1/16W J
R1839	NRSA63J-333X	MG R	33kΩ 1/16W J
R1840	NRSA63J-102X	MG R	1kΩ 1/16W J
R1843-44	NRSA63J-103X	MG R	10kΩ 1/16W J
R1847	NRSA63J-101X	MG R	100Ω 1/16W J
R1850	NRSA63J-0R0X	MG R	0.0Ω 1/16W J
R1867	NRSA63J-474X	MG R	470kΩ 1/16W J
R1880	NRSA63J-102X	MG R	1kΩ 1/16W J
R1881	NRSA63J-221X	MG R	220Ω 1/16W J
R1882	NRSA63J-222X	MG R	2.2kΩ 1/16W J
R1883	NRSA63J-103X	MG R	10kΩ 1/16W J
R1884	NRSA63J-102X	MG R	1kΩ 1/16W J
R1887	NRSA63J-221X	MG R	220Ω 1/16W J
R1888	NRSA63J-222X	MG R	2.2kΩ 1/16W J
R1889	NRSA63J-103X	MG R	10kΩ 1/16W J
R1891-95	NRSA63J-221X	MG R	220Ω 1/16W J
R1896-97	NRSA63J-563X	MG R	56kΩ 1/16W J
R1901	NRSA63J-471X	MG R	470Ω 1/16W J
R1902	NRSA63J-182X	MG R	1.8kΩ 1/16W J
R1904-05	NRSA02F-222X	MG R	2.2kΩ 1/10W F
R1907	NRSA63J-0R0X	MG R	0.0Ω 1/16W J
R1908	NRSA63J-183X	MG R	18kΩ 1/16W J
R1931	NRSA63J-332X	MG R	3.3kΩ 1/16W J
R1932	NRSA63J-101X	MG R	100Ω 1/16W J
R1933	NRSA63J-683X	MG R	68kΩ 1/16W J
R1941	QRK126J-5R6X	C R	5.6Ω 1/2W J
R1942-43	NRSA63J-152X	MG R	1.5kΩ 1/16W J
R1944	QRK126J-220X	C R	22Ω 1/2W J
R1945-46	NRSA63J-102X	MG R	1kΩ 1/16W J
R1947	NRSA63J-152X	MG R	1.5kΩ 1/16W J
R1949	NRSA02F-122X	MG R	1.2kΩ 1/10W F
R1950	NRSA63J-822X	MG R	8.2kΩ 1/16W J
R1952	NRSA63J-0R0X	MG R	0.0Ω 1/16W J
R1953	NRSA63J-224X	MG R	220kΩ 1/16W J
R1954-55	NRSA63J-473X	MG R	47kΩ 1/16W J
R1959	NRSA02F-182X	MG R	1.8kΩ 1/10W F
R1961	NRSA63J-821X	MG R	820Ω 1/16W J
R1962	NRSA63J-682X	MG R	6.8kΩ 1/16W J
R1963	NRSA63J-182X	MG R	1.8kΩ 1/16W J
R1964	NRSA63J-223X	MG R	22kΩ 1/16W J

△ Symbol No.	Part No.	Part Name	Description
RESISTOR			
R1965	NRSA63J-821X	MG R	820Ω 1/16W J
R1966	NRSA63J-123X	MG R	12kΩ 1/16W J
R1967	NRSA63J-122X	MG R	1.2kΩ 1/16W J
R1968-69	NRSA63J-821X	MG R	820Ω 1/16W J
R1981	QRG01GJ-181	OM R	180Ω 1W J
R1986	QRG01GJ-331	OM R	330Ω 1W J
R1991	NRSA63J-273X	MG R	27kΩ 1/16W J
R1992-93	NRSA63J-123X	MG R	12kΩ 1/16W J
R1994	NRSA63J-333X	MG R	33kΩ 1/16W J
R1996-98	NRSA63J-101X	MG R	100Ω 1/16W J
CAPACITOR			
C1001	QETN0JM-108Z	E CAP.	1000μF 6.3V M
C1002-03	NCF31AZ-105X	C CAP.	1μF 10V Z
C1011	NDC31HJ-100X	C CAP.	10pF 50V J
C1012	NCF31CZ-104X	C CAP.	0.1μF 16V Z
C1013	NDC31HJ-5R0X	C CAP.	5.0pF 50V J
C1021	NCF11EZ-105X	C CAP.	1μF 25V Z
C1102	QETN1CM-477Z	E CAP.	470μF 16V M
C1103-04	QETN1HM-106Z	E CAP.	10μF 50V M
C1108	QETN1HM-106Z	E CAP.	10μF 50V M
C1131-33	QETN1EM-476Z	E CAP.	47μF 25V M
C1134	NCF11EZ-105X	C CAP.	1μF 25V Z
C1135-37	NCB11CK-105X	C CAP.	1μF 16V K
C1138	QRN143J-0R0X	C R	0.0Ω 1/4W J
C1139	QRN143J-0R0X	C R	0.0Ω 1/4W J
C1140	QRN143J-0R0X	C R	0.0Ω 1/4W J
C1148	NCB31EK-104X	C CAP.	0.1μF 25V K
C1149	QETN1CM-107Z	E CAP.	100μF 16V M
C1150-52	NCF21CZ-105X	C CAP.	1μF 16V Z
C1160	QETN1CM-107Z	E CAP.	100μF 16V M
C1162	NCB31EK-104X	C CAP.	0.1μF 25V K
C1173-75	NCB11CK-105X	C CAP.	1μF 16V K
C1176-78	NCB31HK-103X	C CAP.	0.01μF 50V K
C1213	QETN1CM-107Z	E CAP.	100μF 16V M
C1214	QETN1HM-225Z	E CAP.	2.2μF 50V M
C1215	QFLC1HJ-103Z	M CAP.	0.01μF 50V J
C1216	NCF11CZ-475X	C CAP.	4.7μF 16V Z
C1218	QENC1HM-105Z	BP E CAP.	1.0μF 50V M
C1219	NCF11CZ-475X	C CAP.	4.7μF 16V Z
C1233	NDC31HJ-180X	C CAP.	18pF 50V J
C1241-42	NCF31CZ-104X	C CAP.	0.1μF 16V Z
C1243	QETN1CM-476Z	E CAP.	47μF 16V M
C1244	NCF31CZ-104X	C CAP.	0.1μF 16V Z
C1245	QETN1CM-476Z	E CAP.	47μF 16V M
C1250-51	NCF31CZ-104X	C CAP.	0.1μF 16V Z
C1252	QENC1EM-106Z	BP E CAP.	10μF 25V M
C1253	NCB31HK-103X	C CAP.	0.01μF 50V K
C1254	QETN1CM-227Z	E CAP.	220μF 16V M
C1255	QETN1HM-474Z	E CAP.	0.47μF 50V M
C1256	NCB11CK-105X	C CAP.	1μF 16V K
C1259-60	NCF31CZ-104X	C CAP.	0.1μF 16V Z
C1261	NDC31HJ-150X	C CAP.	15pF 50V J
C1262	NDC31HJ-471X	C CAP.	470pF 50V J
C1263	NCB31HK-103X	C CAP.	0.01μF 50V K
C1264-65	NDC31HJ-101X	C CAP.	100pF 50V J
C1266	NCF31CZ-104X	C CAP.	0.1μF 16V Z
C1269	QETN1HM-475Z	E CAP.	4.7μF 50V M
C1270-71	QETN1HM-474Z	E CAP.	0.47μF 50V M
C1272	QETN1HM-105Z	E CAP.	1.0μF 50V M
C1273	NCB31HK-472X	C CAP.	4700pF 50V K
C1275	QETN1HM-105Z	E CAP.	1.0μF 50V M
C1276	QETN1CM-227Z	E CAP.	220μF 16V M
C1277-78	NCB31HK-103X	C CAP.	0.01μF 50V K

△ Symbol No.	Part No.	Part Name	Description
CAPACITOR			
C1301-03	QENC1HM-105Z	BP E CAP.	1.0μF 50V M
C1304	QETN1HM-105Z	E CAP.	1.0μF 50V M
C1305	NCF11CZ-475X	C CAP.	4.7μF 16V Z
C1306	QETN1AM-477Z	E CAP.	470μF 10V M
C1307	NCB31HK-472X	C CAP.	4700pF 50V K
C1308-13	NCB31CK-104X	C CAP.	0.1μF 16V K
C1315-16	NCB31HK-472X	C CAP.	4700pF 50V K
C1317	QETN1CM-227Z	E CAP.	220μF 16V M
C1318	QETN1HM-225Z	E CAP.	2.2μF 50V M
C1319	QETN1HM-105Z	E CAP.	1.0μF 50V M
C1320	QETN1HM-475Z	E CAP.	4.7μF 50V M
C1321-23	QETN1HM-335Z	E CAP.	3.3μF 50V M
C1325-27	NCB11CK-105X	C CAP.	1μF 16V K
C1329	NCB31HK-103X	C CAP.	0.01μF 50V K
C1332-34	NCB21AK-105X	CHIP CAP.	1μF 10V K
C1335	QETN1EM-476Z	E CAP.	47μF 25V M
C1336	NCB31HK-472X	C CAP.	4700pF 50V K
C1339	NCF11CZ-475X	C CAP.	4.7μF 16V Z
C1341-46	NCF11EZ-105X	C CAP.	1μF 25V Z
C1351	NCF31AZ-105X	C CAP.	1μF 10V Z
C1352	NDC31HJ-151X	C CAP.	150pF 50V J
C1357	NCB31HK-102X	C CAP.	1000pF 50V K
C1358	NDC31HJ-100X	C CAP.	10pF 50V J
C1359	NCB31HK-472X	C CAP.	4700pF 50V K
C1361	QETN1HM-226Z	E CAP.	22μF 50V M
C1362	NCB31CK-563X	CHIP CAP.	0.056μF 16V K
C1363	QETN1HM-226Z	E CAP.	22μF 50V M
C1364	NCB31CK-104X	C CAP.	0.1μF 16V K
C1366	NCF11EZ-105X	C CAP.	1μF 25V Z
C1381-82	NCF11CZ-475X	C CAP.	4.7μF 16V Z
C1386	NCF31AZ-105X	C CAP.	1μF 10V Z
C1391	NCF31AZ-105X	C CAP.	1μF 10V Z
C1401	QETN1AM-477Z	E CAP.	470μF 10V M
C1402	QETN0JM-108Z	E CAP.	1000μF 6.3V M
C1403	QETN1CM-107Z	E CAP.	100μF 16V M
C1404	QETN1AM-108Z	E CAP.	1000μF 10V M
C1405	QETN0JM-108Z	E CAP.	1000μF 6.3V M
C1409	QETN1HM-106Z	E CAP.	10μF 50V M
C1410-11	NCB31CK-104X	C CAP.	0.1μF 16V K
C1413	NCB31HK-103X	C CAP.	0.01μF 50V K
C1414	QETN1EM-476Z	E CAP.	47μF 25V M
C1415	NCB31HK-103X	C CAP.	0.01μF 50V K
C1416	QETN1EM-476Z	E CAP.	47μF 25V M
C1417	NCB31HK-103X	C CAP.	0.01μF 50V K
C1418	QETN1EM-476Z	E CAP.	47μF 25V M
C1424-26	QETN1CM-336Z	E CAP.	33μF 16V M
C1428	QRN143J-0R0X	C R	0.0Ω 1/4W J
C1429	QRN143J-0R0X	C R	0.0Ω 1/4W J
C1438	NCB31HK-103X	C CAP.	0.01μF 50V K
C1442	NCB31HK-103X	C CAP.	0.01μF 50V K
C1444	NCB11CK-225X	C CAP.	2.2μF 16V K
C1445	NCB31HK-103X	C CAP.	0.01μF 50V K
C1446	NCB31HK-102X	C CAP.	1000pF 50V K
C1447	NDC31HJ-151X	C CAP.	150pF 50V J
C1449	NDC31HJ-560X	C CAP.	56pF 50V J
C1450-51	NCB31HK-103X	C CAP.	0.01μF 50V K
C1452	NCB31HK-102X	C CAP.	1000pF 50V K
C1453	NCB31AK-474X	CHIP CAP.	0.47μF 10V K
C1454	NCB11CK-225X	C CAP.	2.2μF 16V K
C1480-81	NCB31HK-103X	C CAP.	0.01μF 50V K
C1482	NCB11CK-225X	C CAP.	2.2μF 16V K
C1483-84	NCB31HK-103X	C CAP.	0.01μF 50V K
C1485	NCB31HK-102X	C CAP.	1000pF 50V K
C1486	NDC31HJ-151X	C CAP.	150pF 50V J

△ Symbol No.	Part No.	Part Name	Description
CAPACITOR			
C1487	NCB31HK-102X	C CAP.	1000pF 50V K
C1488	NDC31HJ-7R0X	C CAP.	7.0pF 50V J
C1489	NDC31HJ-560X	C CAP.	56pF 50V J
C1490	NCB31HK-103X	C CAP.	0.01μF 50V K
C1491	NCB11CK-225X	C CAP.	2.2μF 16V K
C1501	NCB31EK-104X	C CAP.	0.1μF 25V K
C1502	QETN1EM-476Z	E CAP.	47μF 25V M
C1519	QETN1EM-476Z	E CAP.	47μF 25V M
C1520	NDC31HJ-100X	C CAP.	10pF 50V J
C1521	QENC1CM-336Z	BP E CAP.	33μF 16V M
C1522	NCB31HK-103X	C CAP.	0.01μF 50V K
C1532	QETN1HM-226Z	E CAP.	22μF 50V M
C1539	QETN1HM-106Z	E CAP.	10μF 50V M
C1560	NCF11EZ-105X	C CAP.	1μF 25V Z
C1579	QETN1EM-476Z	E CAP.	47μF 25V M
C1582	QENC1CM-336Z	BP E CAP.	33μF 16V M
C1583	NCB11CK-225X	C CAP.	2.2μF 16V K
C1663	NRSA63J-0R0X	MG R	0.0Ω 1/16W J
C1665	NRSA63J-0R0X	MG R	0.0Ω 1/16W J
C1667	QETN1HM-106Z	E CAP.	10μF 50V M
C1668	NDC31HJ-101X	C CAP.	100pF 50V J
C1669	NCB11CK-105X	C CAP.	1μF 16V K
C1670	QETN1HM-106Z	E CAP.	10μF 50V M
C1671	NDC31HJ-101X	C CAP.	100pF 50V J
C1672	NCB11CK-105X	C CAP.	1μF 16V K
C1673	QETN1HM-107Z	E CAP.	100μF 50V M
C1674	QETN1VM-228	E CAP.	2200μF 35V M
C1675-76	QFV71HJ-124Z	MF CAP.	0.12μF 50V J
C1677-78	QETN1EM-108Z	E CAP.	1000μF 25V M
C1679	QETN1HM-475Z	E CAP.	4.7μF 50V M
C1680	QETN1HM-106Z	E CAP.	10μF 50V M
C1696	QETN1HM-106Z	E CAP.	10μF 50V M
C1697	QETN1EM-476Z	E CAP.	47μF 25V M
C1701	NCB31EK-104X	C CAP.	0.1μF 25V K
C1702	NCB11CK-225X	C CAP.	2.2μF 16V K
C1703	QETN1EM-476Z	E CAP.	47μF 25V M
C1704	NCB11CK-225X	C CAP.	2.2μF 16V K
C1706	NCB11CK-105X	C CAP.	1μF 16V K
C1708	NDC31HJ-470X	C CAP.	47pF 50V J
C1709	NDC31HJ-101X	C CAP.	100pF 50V J
C1710	NCB31EK-104X	C CAP.	0.1μF 25V K
C1711	NCF31CZ-104X	C CAP.	0.1μF 16V Z
C1712	QETN1HM-106Z	E CAP.	10μF 50V M
C1715	NDC31HJ-102X	C CAP.	1000pF 50V J
C1716	NCB31HK-103X	C CAP.	0.01μF 50V K
C1717	NCF31CZ-104X	C CAP.	0.1μF 16V Z
C1718	QETN1EM-476Z	E CAP.	47μF 25V M
C1719	QETN1HM-475Z	E CAP.	4.7μF 50V M
C1720	NDC31HJ-102X	C CAP.	1000pF 50V J
C1721	NCB31HK-103X	C CAP.	0.01μF 50V K
C1722	QETN1HM-475Z	E CAP.	4.7μF 50V M
C1723	NCB31HK-152X	C CAP.	1500pF 50V K
C1724	QETN1HM-105Z	E CAP.	1.0μF 50V M
C1725	NDC31HJ-470X	C CAP.	47pF 50V J
C1726-27	QETN1HM-105Z	E CAP.	1.0μF 50V M
C1728	NCB21AK-105X	CHIP CAP.	1μF 10V K
C1729	QETN1EM-476Z	E CAP.	47μF 25V M
C1730-31	QETN1HM-105Z	E CAP.	1.0μF 50V M
C1732	NCB31HK-103X	C CAP.	0.01μF 50V K
C1733	QETN1HM-475Z	E CAP.	4.7μF 50V M
C1734	NDC31HJ-470X	C CAP.	47pF 50V J
C1735	NCB31HK-153X	C CAP.	0.015μF 50V K
C1743	NDC31HJ-220X	C CAP.	22pF 50V J
C1744	NDC31HJ-150X	C CAP.	15pF 50V J

△ Symbol No.	Part No.	Part Name	Description
CAPACITOR			
C1745	NCB31HK-153X	C CAP.	0.015μF 50V K
C1752	NCB11CK-105X	C CAP.	1μF 16V K
C1754	NCB31HK-122X	CHIP CAP.	1200pF 50V K
C1755	QETN1HM-105Z	E CAP.	1.0μF 50V M
C1756	NCB31HK-122X	CHIP CAP.	1200pF 50V K
C1757	QETN1HM-105Z	E CAP.	1.0μF 50V M
C1801	NDC31HJ-391X	C CAP.	390pF 50V J
C1802	QETN1HM-106Z	E CAP.	10μF 50V M
C1901	QETN1EM-107Z	E CAP.	100μF 25V M
C1902	QETN1CM-107Z	E CAP.	100μF 16V M
C1908-09	QETN1CM-107Z	E CAP.	100μF 16V M
C1932	QETN1EM-476Z	E CAP.	47μF 25V M
C1941	QETN1VM-108Z	E CAP.	1000μF 35V M
C1942	QETN1CM-108Z	E CAP.	1000μF 16V M
C1944	QETN1VM-108Z	E CAP.	1000μF 35V M
C1945	QEZ0256-128	E CAP.	1200μF 10V M
C1947-48	QETN1CM-477Z	E CAP.	470μF 16V M
C1949-50	QETNOJM-108Z	E CAP.	1000μF 6.3V M
C1951	QETN1VM-108Z	E CAP.	1000μF 35V M
C1952	QEZ0256-128	E CAP.	1200μF 10V M
C1953-54	QETNOJM-108Z	E CAP.	1000μF 6.3V M
C1957	QETNOJM-108Z	E CAP.	1000μF 6.3V M
C1958	QETNOJM-228Z	E CAP.	2200μF 6.3V M
C1961	QETN1HM-105Z	E CAP.	1.0μF 50V M
C1988	NCB31HK-222X	C CAP.	2200pF 50V K
COIL			
L1101	QRN143J-0R0X	C R	0.0Ω 1/4W J
L1102	QRN143J-0R0X	C R	0.0Ω 1/4W J
L1211	QQL25CK-100Z	COIL	10μH K
L1243-44	NQL024J-100X	COIL	10μH K
L1401	QQL25CK-100Z	COIL	10μH K
L1402	QQL26AK-100Z	CHOKE COIL	
L1403	QRN143J-0R0X	C R	0.0Ω 1/4W J
L1404	QRN143J-0R0X	C R	0.0Ω 1/4W J
L1430-31	NQL085J-560X	INDUCTOR	
L1481-82	NQL085J-560X	INDUCTOR	
L1711	NQL085J-1R5X	CHIP INDUCTOR	
L1712-14	NQL085J-3R3X	INDUCTOR	
L1941	QQR1129-001	CHOKE COIL	
L1942	QQR1127-001	CHOKE COIL	
L1943	QQL50AK-330Z	CHOKE COIL	
L1944	QQL26AK-330Z	COIL	33μH K
L1945-46	QQL26AK-220Z	COIL	22μH K
L1947	QQR1127-001	CHOKE COIL	
L1948	QQL50AK-100Z	CHOKE COIL	
L1949	QQL26AK-220Z	COIL	22μH K
L1950	QQL26AK-820Z	COIL	82μH K
DIODE			
D1304	MA111-X	SI DIODE	
D1306	MA111-X	SI DIODE	
D1308	MA8100/M/-X	ZENER DIODE	
D1309-10	MA111-X	SI DIODE	
D1352	MA111-X	SI DIODE	
D1353	MA8150/M/-X	ZENER DIODE	
D1354	MA8030/H/-X	ZENER DIODE	
D1431-32	MA111-X	SI DIODE	
D1481-82	MA111-X	SI DIODE	
D1662-63	MA3330/L/-X	ZENER DIODE	
D1667-69	MA111-X	SI DIODE	
D1701	1SR35-400A-T5	SI DIODE	
D1702	MA111-X	SI DIODE	
D1704	MA111-X	SI DIODE	
D1708-09	MA111-X	SI DIODE	

Symbol No.	Part No.	Part Name	Description	
DIODE				
D1713-16	MA111-X	SI. DIODE	0.0Ω 1/16W J	
D1718	MA111-X	SI. DIODE		
D1719	NRSAG3J-OROX	MG R		
D1721-22	MA704A-X	SI. DIODE		
D1891-92	UDZ58.2B-X	ZENER DIODE		
D1893-95	UDZ55.1B-X	ZENER DIODE		
D1901	1SR35-400A-T5	SI. DIODE		
D1903	1SR35-400A-T5	SI. DIODE		
D1931-32	MA111-X	SI. DIODE		
D1933	UDZ55.1B-X	ZENER DIODE		
D1941	RK34-LFC4	SI. DIODE		
D1942-43	SF554	SI. DIODE		
D1962	MA3030/H/-X	ZENER DIODE		
D1964-65	MA111-X	SI. DIODE		
D1967	PTZ11B-X	ZENER DIODE		
D1968	PTZ6.8B-X	ZENER DIODE		
D1969	PTZ11B-X	ZENER DIODE		
D1970	MA111-X	SI. DIODE		
TRANSISTOR				
Q1001	2SC2412K/QR/-X	SI. TRANSISTOR		
Q1021	2SC2412K/QR/-X	SI. TRANSISTOR		
Q1151-53	2SC3837K/NP/-X	SI. TRANSISTOR		
Q1232	2SA1037AK/QR/-X	SI. TRANSISTOR		
Q1242-43	2SC2412K/QR/-X	SI. TRANSISTOR		
Q1246	2SC2412K/QR/-X	SI. TRANSISTOR		
Q1248-49	2SA1037AK/QR/-X	SI. TRANSISTOR		
Q1301-03	2SA1022/BC/-X	SI. TRANSISTOR		
Q1304-06	2SC3837K/NP/-X	SI. TRANSISTOR		
Q1307	2SC2412K/QR/-X	SI. TRANSISTOR		
Q1321	IMX1-XW	SI. TRANSISTOR		
Q1323	2SC2412K/QR/-X	SI. TRANSISTOR		
Q1324	2SA1022/BC/-X	SI. TRANSISTOR		
Q1331-33	2SC3837K/NP/-X	SI. TRANSISTOR		
Q1431	2SC2412K/QR/-X	SI. TRANSISTOR		
Q1432	2SA1037AK/QR/-X	SI. TRANSISTOR		
Q1433	2SC2412K/QR/-X	SI. TRANSISTOR		
Q1436-38	2SC2412K/QR/-X	SI. TRANSISTOR		
Q1439	2SA1037AK/QR/-X	SI. TRANSISTOR		
Q1481-84	2SC2412K/QR/-X	SI. TRANSISTOR		
Q1485	2SA1037AK/QR/-X	SI. TRANSISTOR		
Q1505	2SC2412K/QR/-X	SI. TRANSISTOR		
Q1668	DTC144EKA-X	DIGI. TRANSISTOR		
Q1669	2SC2412K/QR/-X	SI. TRANSISTOR		
Q1672	2SC2412K/QR/-X	SI. TRANSISTOR		
Q1673	2SA1037AK/QR/-X	SI. TRANSISTOR		
Q1701	DTC144EKA-X	DIGI. TRANSISTOR		
Q1702-05	2SA1037AK/QR/-X	SI. TRANSISTOR		
Q1706-07	2SC2412K/QR/-X	SI. TRANSISTOR		
Q1710-11	2SC2412K/QR/-X	SI. TRANSISTOR		
Q1714	2SC2785/JH/-T	SI. TRANSISTOR		
Q1715	2SA1037AK/QR/-X	SI. TRANSISTOR		
Q1931	2SC2412K/QR/-X	SI. TRANSISTOR		
Q1961-62	2SC2412K/QR/-X	SI. TRANSISTOR		
Q1964-65	2SC2412K/QR/-X	SI. TRANSISTOR		
Q1981	2SC4682-T	SI. TRANSISTOR		
Q1984	2SC4682-T	SI. TRANSISTOR		

Symbol No.	Part No.	Part Name	Description
IC			
IC1001	TC74HC02AF-X	I.C. (DIGI-MOS)	
IC1002	TC74HC14AF-X	I.C. (DIGI-MOS)	
IC1011	TC7W04F-X	I.C. (DIGI-MOS)	
IC1021	TC4W66F-X	I.C. (DIGI-MOS)	
IC1131	M52055FP-X	I.C. (MONO-ANA)	
IC1151	MM1519XQ	I.C. (MONO-ANA)	
IC1211	TA1318N	I.C. (M)	
IC1212	TC7W08F-X	I.C. (ECL-LOGIC)	
IC1241	CXA2019AQ	I.C. (MONO-ANA)	
IC1242	TA78L09F-X	I.C. (MONO-ANA)	
IC1301	AN5392FBQ	I.C. (MONO-ANA)	
IC1302	CXA1875AM-X	I.C. (MONO-ANA)	
IC1351	TC74HC4538AF-X	I.C. (DIGI-MOS)	
IC1431	TC4W66F-X	I.C. (DIGI-MOS)	
IC1501	CXA2069Q	I.C. (MONO-ANA)	
IC1502	M62320FP-X	I.C. (M)	
IC1511	PQ15RW11	I.C. (MONO-ANA)	
IC1521	CE42599-002	COMB FILTER	
IC1560	BU2098F-X	I.C. (DIGI-MOS)	
IC1661	AN5277	I.C. (MONO-ANA)	
IC1701	MN102HS7KPB	IC	
IC1702	S-80828ALNP-W	I.C. (MONO-ANA)	
IC1703	AT24C32-48WP30	I.C.	(SERVICE)
IC1704	TA48M033F-X	I.C. (M)	
IC1852	S-80840ALNP-W	I.C. (MONO-ANA)	
IC1901	PQ12RF1	I.C.	
IC1903	BA17805T	I.C. (MONO-ANA)	
IC1941	SI-80905	I.C. (HYBRID)	
IC1942	SI-80505	I.C. (HYBRID)	
IC1943	PQ1CG2032FZ	I.C. (MONO-ANA)	
IC1944	PQ070XH02Z-W	I.C. (M)	
OTHERS			
CF1241	QAX0529-001	CER. RESONATOR	
CN1007	QGB1505J1-25	CONNECTOR	
K1151	NRSA63J-OROX	MG R	0.0Ω 1/16W J
K1703	NQR0199-004X	FERRITE BEADS	
K1704-05	NQR0413-003X	BEADS CORE	
K1941	QRN143J-OROX	C R	0.0Ω 1/4W J
K1942	QRN143J-OROX	C R	0.0Ω 1/4W J
K1943	CE42050-001Z	CORE	
K1944	CE42050-001Z	CORE	
SL1211	CSB503F30-T2	CER. RESONATOR	
SL1701	QAX0248-001Z	CER. RESONATOR	
TU1101	QAU0206-001	TUNER	
X1241	CE41651-001Z	CRYSTAL	

POWER & DEF. P.W. BOARD ASS'Y

(SSB-2051A-M2)

△ Symbol No.	Part No.	Part Name	Description
RESISTOR			
R2201	QRA14CF-1803Y	MF R	180kΩ 1/4W F
R2202	QRA14CF-2703Y	MF R	270kΩ 1/4W F
R2203	QRA14CF-2703Y	MF R	270kΩ 1/4W F
R2401	QRE141J-562Y	C R	5.6kΩ 1/4W J
R2402	QRE141J-103Y	C R	10kΩ 1/4W J
R2403	QRE121J-180Y	C R	18Ω 1/2W J
R2404	QRA14CF-6801Y	MF R	6.8kΩ 1/4W F
R2405	QRA14CF-6801Y	MF R	6.8kΩ 1/4W F
R2406	QRA14CF-1002Y	MF R	10kΩ 1/4W F
R2407-08	QRA14CF-8200Y	MF R	820Ω 1/4W F
R2409	QRL029J-221	OM R	220Ω 2W J
R2410	QRT029J-2R2	MF R	2.2Ω 2W J
R2411	QRE121J-8R2Y	C R	8.2Ω 1/2W J
R2412	QRE141J-472Y	C R	4.7kΩ 1/4W J
R2413	QRE141J-104Y	C R	100kΩ 1/4W J
R2415	QRE141J-154Y	C R	150kΩ 1/4W J
R2416	QRE141J-103Y	C R	10kΩ 1/4W J
R2418	QRE141J-222Y	C R	2.2kΩ 1/4W J
R2420	QRE141J-101Y	C R	100Ω 1/4W J
R2421	QRE141J-682Y	C R	6.8kΩ 1/4W J
R2430-32	QRE121J-101Y	C R	100Ω 1/2W J
R2501	QRE141J-471Y	C R	470Ω 1/4W J
R2502	QRE121J-123Y	C R	12kΩ 1/2W J
R2503	QRE121J-152Y	C R	1.5kΩ 1/2W J
R2504	QRL039J-272	OM R	2.7kΩ 3W J
R2505	QRL039J-332	OM R	3.3kΩ 3W J
R2506	QRE121J-5R6Y	C R	5.6Ω 1/2W J
R2512	QRL029J-821	OM R	820Ω 2W J
R2521	QRE141J-104Y	C R	100kΩ 1/4W J
R2522	QRE141J-103Y	C R	10kΩ 1/4W J
R2523	QRE141J-822Y	C R	8.2kΩ 1/4W J
R2524	QRE141J-682Y	C R	6.8kΩ 1/4W J
R2525	QRE141J-102Y	C R	1kΩ 1/4W J
R2526	QRE141J-470Y	C R	47Ω 1/4W J
R2531	QRL029J-102	OM R	1kΩ 2W J
R2532-33	QRL029J-820	OM R	82Ω 2W J
R2534	QRE141J-102Y	C R	1kΩ 1/4W J
R2535-36	QRE141J-470Y	C R	47Ω 1/4W J
R2561	QRA14CF-4701Y	MF R	4.7kΩ 1/4W F
R2562	QRA14CF-5601Y	MF R	5.6kΩ 1/4W F
R2565	QRE141J-223Y	C R	22kΩ 1/4W J
R2591	QRF154K-3R3	UNF R	3.3Ω 15W K
R2701	QRL01EJ-220X	OM R	22Ω 1W J
R2702	QRE121J-123Y	C R	12kΩ 1/2W J
R2703	QRZ0056-103Z	COMP R	10kΩ 1/2W K
R2901	QRF154K-R51	UNF R	0.51Ω 15W K
R2902	QRG01GJ-470	OM R	47Ω 1W J
R2903	QRF154K-R51	UNF R	0.51Ω 15W K
R2910	QRE121J-152Y	C R	1.5kΩ 1/2W J
R2911	QRL029J-183	OM R	18kΩ 2W J
R2912-13	QRT029J-R18	MF R	0.18Ω 2W J
△ R2914	QRK126J-681X	C R	680Ω 1/2W J
R2916	QRT029J-R22	MF R	0.22Ω 2W J
△ R2917	QRK126J-332X	C R	3.3kΩ 1/2W J
R2918	QRE121J-152Y	C R	1.5kΩ 1/2W J
R2920	QRE121J-684Y	C R	680kΩ 1/2W J
R2941	QRL039J-333	OM F	33kΩ 3W J
R2944	QRE121J-222Y	C R	2.2kΩ 1/2W J
R2951	QRE141J-473Y	C R	47kΩ 1/4W J
R2952	QRE141J-222Y	C R	2.2kΩ 1/4W J
R2953	QRE121J-181Y	C R	180Ω 1/2W J
R2954	QRE121J-221Y	C R	220Ω 1/2W J
R2959	QRE121J-121Y	C R	120Ω 1/2W J
R2960	QRE141J-473Y	C R	47kΩ 1/4W J

△ Symbol No.	Part No.	Part Name	Description
RESISTOR			
R2961	QRE141J-103Y	C R	10kΩ 1/4W J
R2962	QRE141J-472Y	C R	4.7kΩ 1/4W J
R2963	QRA14CF-4701Y	MF R	4.7kΩ 1/4W F
R2964	QRA14CF-4701Y	MF R	4.7kΩ 1/4W F
R2965	QRE141J-333Y	C R	33kΩ 1/4W J
R2966	QRE141J-473Y	C R	47kΩ 1/4W J
R2967	QRE141J-473Y	C R	47kΩ 1/4W J
R2968	QRA14CF-1802Y	MF R	18kΩ 1/4W F
R2972	QRA14CF-1101Y	MF R	1.1kΩ 1/4W F
R2973	QRA14CF-7501Y	MF R	7.5kΩ 1/4W F
R2975	QRE121J-223Y	C R	22kΩ 1/2W J
R2977	QRE141J-473Y	C R	47kΩ 1/4W J
R2978	QRE141J-333Y	C R	33kΩ 1/4W J
△ R2999	QRZ0111-685	C R	6.8MΩ 1/2W K
CAPACITOR			
C2201	QFV71HJ-334Z	MF CAP.	0.33μF 50V J
C2401	QETN1VM-108Z	E CAP.	1000μF 35V M
C2402	QFN31HJ-152Z	M CAP.	1500pF 50V J
C2403	QCS32HJ-180Z	C CAP.	18pF 500V J
C2404	QFLC2AJ-104Z	M CAP.	0.1μF 100V J
C2405	QFV71HJ-104Z	MF CAP.	0.1μF 50V J
C2406	QETN1VM-107Z	E CAP.	100μF 35V M
C2407	QETN1HM-105Z	E CAP.	1.0μF 50V M
C2408	QFLC2AJ-104Z	M CAP.	0.1μF 100V J
C2409	QETN1HM-106Z	E CAP.	10μF 50V M
C2411	QCB31HK-222Z	C CAP.	2200pF 50V K
C2412-13	QENC1CM-226Z	BP E CAP.	22μF 16V M
C2416	QCB31HK-682Z	C CAP.	6800pF 50V K
C2417	QETN1VM-107Z	E CAP.	100μF 35V M
C2501	QCB32HK-331Z	C CAP.	330pF 500V K
C2502	QFN32DK-103	M CAP.	0.01μF 200V K
C2503	QFV71HJ-224Z	MF CAP.	0.22μF 50V J
△ C2506	QFZ0122-452	MPP CAP.	4500pF 1.8kVH±3%
△ C2507	QFZ0122-392	MPP CAP.	3900pF 1.8kVH±3%
C2508	QFP32JJ-153	PP CAP.	0.015μF 630V J
△ C2509	QFZ0128-154	MPP CAP.	0.15μF 400V±3%
△ C2510	QFZ0197-154	MPP CAP.	0.15μF 250V J
△ C2511	QFZ0128-254	MPP CAP.	0.25μF 400V±3%
C2513	QEZ0414-226	E CAP.	22μF 50V M
C2514	QCS32HJ-561	C CAP.	560pF 500V J
C2521-22	QCZ0122-681	C CAP.	680pF 2kV K
C2523	QFN32AJ-682Z	M CAP.	6800pF 100V J
C2524	QCS31HJ-470Z	C CAP.	47pF 50V J
C2525	QCB31HK-682Z	C CAP.	6800pF 50V K
C2527	QETN1EM-476Z	E CAP.	47μF 25V M
C2533	QCS32HJ-561	C CAP.	560pF 500V J
C2534	QFN32DK-222Z	M CAP.	2200pF 200V K
C2536	QFN32DK-222Z	M CAP.	2200pF 200V K
C2562	QETN1HM-475Z	E CAP.	4.7μF 50V M
C2591	QEZ0203-107	E CAP.	100μF 160V M
C2701	QFLC2AJ-273Z	M CAP.	0.027μF 100V J
C2801-02	QETN1EM-108Z	E CAP.	1000μF 25V M
C2803	QETM2EM-336	E CAP.	33μF 250V M
C2811	QETN1VM-107Z	E CAP.	100μF 35V M
△ C2902	QFZ9072-104	MF CAP.	0.1μFAC275V K
△ C2904	QCZ9054-102	C CAP.	1000pFAC250V Z
△ C2905	QCZ9054-102	C CAP.	1000pFAC250V Z
△ C2906	QCZ9054-102	C CAP.	1000pFAC250V Z
C2907	QEZ0572-128	E CAP.	1200μF 25V M
△ C2908	QCZ9054-102	C CAP.	1000pFAC250V Z
C2912	QCZ0340-332	C CAP.	3300pF 2kV K
C2913	QFLC1HJ-471Z	M CAP.	470pF 50V J

△ Symbol No.	Part No.	Part Name	Description
CAPACITOR			
C2914	QETN1HM-227Z	E CAP.	220μF 50V M
C2916	QCS31HJ-331Z	C CAP.	330pF 50V J
C2917	QFN31HJ-182Z	M CAP.	1800pF 50V J
C2918	QFV71HJ-104Z	MF CAP.	0.1μF 50V J
C2919	QFP32GJ-103Z	PP CAP.	0.01μF 400V J
C2920	QCZ0115-151Z	C CAP.	150pF 2KV K
C2930	QCS31HJ-181Z	C CAP.	180pF 50V J
C2931	QEZO203-227	E CAP.	220μF 160V M
C2932	QETM1EM-228	E CAP.	2200μF 25V M
C2934-35	QETM1VM-228	E CAP.	2200μF 35V M
C2937	QCZ0131-821	C CAP.	820pF 2KV K
C2942	QETN1HM-105Z	E CAP.	1.0μF 50V M
C2943	QETN1CM-477Z	E CAP.	470μF 16V M
C2944	QETN1CM-227Z	E CAP.	220μF 16V M
C2945	QETM1VM-228	E CAP.	2200μF 35V M
C2946	QETN1VM-227Z	E CAP.	220μF 35V M
C2971	QETN1CM-107Z	E CAP.	100μF 16V M
C2972	QETN1EM-476Z	E CAP.	47μF 25V M
C2973	QETN1HM-106Z	E CAP.	10μF 50V M
△ C2993	QCZ9074-472	C CAP.	4700pFAC250V M
△ C2994	QCZ9074-472	C CAP.	4700pFAC250V M
△ C2995	QCZ9074-472	C CAP.	4700pFAC250V M
△ C2997	QCZ9074-472	C CAP.	4700pFAC250V M
△ C2998	QCZ9074-472	C CAP.	4700pFAC250V M
△ C2999	QCZ9074-472	C CAP.	4700pFAC250V M
TRANSFORMER			
△ T2501	QQR1111-001	DRIVE TRANSF.	
△ T2502	QQH0113-001	H.V. TRANSF.	
△ T2701	QQR1096-001	DEF. TRANSF.	
△ T2921	QQS0133-001	SW TRANSF.	
COIL			
L2501	QQLZ025-180	CHOKE COIL	
L2502	QQR1230-001	CHOKE COIL	
L2504	QQR0915-003	LINEARITY COIL	
L2531	QQL43AJ-222	COIL	2.2mH J
L2701	QQL43AJ-222	COIL	2.2mH J
L2801	QQLZ026-140	HEATER CHOKE	
L2931	QQL26AK-470Z	COIL	47μH K
L2933	QQL26AK-470Z	COIL	47μH K
L2934	QQLZ018-220	HEATER CHOKE	
L2935	QQL60AK-220	INDUCTOR	
L2936	QQL26AK-220Z	COIL	22μH K
DIODE			
D2201	1SR35-400A-T2	SI. DIODE	
D2401	MTZJ75-T2	ZENER DIODE	
D2402	1SR35-400A-T2	SI. DIODE	
D2403	1SS133-T2	SI. DIODE	
D2404	MTZJ9.1B-T2	ZENER DIODE	
D2405	1SS133-T2	SI. DIODE	
D2406	MTZJ6.8C-T2	ZENER DIODE	
D2407	1SR35-400A-T2	SI. DIODE	
D2501	1SS81-T5	SI. DIODE	
D2504	RG2A-LFC4	SI. DIODE	
D2505	V11CA-C1	SI. DIODE	
D2506	FMV-3FU-F1	SI. DIODE	
D2521	MTZJ12C-T2	ZENER DIODE	
D2522	1SS81-T5	SI. DIODE	
D2531	RGPI0J-5025-T3	SI. DIODE	
D2561	MTZJ7.5S-T2	ZENER DIODE	
D2562	MTZJ7.5S-T2	ZENER DIODE	
D2583	1SS133-T2	SI. DIODE	
D2801	EU2-T3	SI. DIODE	

△ Symbol No.	Part No.	Part Name	Description
DIODE			
D2802	EU2-T3	SI. DIODE	
D2803	RU30A-F1	SI. DIODE	
△ D2811	1SR124-400A-T2	SI. DIODE	
D2901	RBV-606	SI. DIODE	
D2910	MA700A-T2	SI. DIODE	
D2911	RGPI0J-5025-T3	SI. DIODE	
D2912	AU01Z-T2	SI. DIODE	
D2913	AU01Z-T2	SI. DIODE	
D2914	1SS133-T2	SI. DIODE	
D2915	SARS01-T2	SI. DIODE	
D2916	1SS133-T2	SI. DIODE	
D2917	MTZJ27B-T2	ZENER DIODE	
D2918	MTZJ5.1B-T2	ZENER DIODE	
D2920	1SS133-T2	SI. DIODE	
D2931	RU4AM-F1	SI. DIODE	
D2932	RU30A-F1	SI. DIODE	
D2934	RU4AM-F1	SI. DIODE	
D2935	RU3YX-LFC4	SI. DIODE	
D2936	FMX-G12S	SI. DIODE	
D2937	EU2-T3	SI. DIODE	
D2938	FMX-G12S	SI. DIODE	
D2941	MTZJ33B-T2	ZENER DIODE	
D2952	MTZJ12C-T2	ZENER DIODE	
D2953	1SS244-T2	SI. DIODE	
D2954	1SS133-T2	SI. DIODE	
D2956	1SS133-T2	SI. DIODE	
D2958	MTZJ6.8C-T2	ZENER DIODE	
D2959	1SS133-T2	SI. DIODE	
D2972	MTZJ15B-T2	ZENER DIODE	
D2973	1SS133-T2	SI. DIODE	
TRANSISTOR			
Q2401-02	2SC3311A/QR/-T	SI. TRANSISTOR	
△ Q2501	BSN304-T	F. E. T.	H. OUT
Q2503	2SC5552-RL	SI. TRANSISTOR	
Q2521	2SC3311A/QR/-T	SI. TRANSISTOR	
Q2531	IRFI620G	F. E. T.	
Q2532	2SC1959/Y/-T	SI. TRANSISTOR	
Q2533	2SA562TM/Y/-T	SI. TRANSISTOR	
Q2951	2SC1627A/Y/-T	SI. TRANSISTOR	
Q2952-54	2SC3311A/QR/-T	SI. TRANSISTOR	
Q2971	2SA1208/ST/Z1-T	SI. TRANSISTOR	
IC			
IC2401	LA7876NZ	I. C. (MONO-ANA)	
IC2911	STR-F6629B/F7	I. C.	
IC2921	SE140N	I. C. (HYBRID)	
OTHERS			
CN2001-03	QGB1506M1-16	CONNECTOR	
CN2010	QGB1505J1-35	RECEPTACLE	
△ CP2934	ICP-N70-T	I. C. PROTECT	
△ CP2936	ICP-N38-Y	I. C. PROTECT	
△ CP2941	ICP-N70-T	I. C. PROTECT	
△ CP2942	ICP-N70-T	I. C. PROTECT	
△ CP2943	ICP-N20-Y	I. C. PROTECT	
△ F2905	QMFZ034-SR0Z-J1	FUSE	5.0A
△ FR2801	QRZ9011-1R0	F R	1.0 Ω 1/2W J
△ FR2802	QRZ9011-1R0	F R	1.0 Ω 1/2W J
△ FR2811	QRZ9011-4R7	F R	4.7 Ω 1/2W J
△ FR2915	QRZ9017-330	FUSI. RESISTOR	33 Ω 1/4W J
K2401	QQR0621-002Z	BEADS CORE	
K2504-05	QQR0679-001	FERRITE BEADS	
K2912	QQR0582-001Z	BEADS CORE	
K2914	QQR0582-001Z	BEADS CORE	

△ Symbol No.	Part No.	Part Name	Description
OTHERS			
K2930	QQR0621-002Z	BEADS CORE	
K2931	QQR0621-002Z	BEADS CORE	
K2935	QQR0621-002Z	BEADS CORE	
K2937	QQR0621-002Z	BEADS CORE	
K2938	QQR0621-002Z	BEADS CORE	
△ RY2951	QSK0118-001	RELAY	
△ RY2952	QSK0083-001	RELAY	
△ PC2921	PC123F2	I.C. (PH.COUPLER)	

R CRT SOCKET P.W. BOARD ASS'Y (SSB-3151A-M2)

△ Symbol No.	Part No.	Part Name	Description
RESISTOR			
R3005	QRE121J-105Y	C R	1MΩ 1/2W J
R3006	QRC121K-102Z	COMP.R	1kΩ 1/2W K
R3008	QRC121K-152Z	COMP.R	1.5kΩ 1/2W K
R3101	NRSA63J-681X	MG R	680Ω 1/16W J
R3103	NRSA63J-821X	MG R	820Ω 1/16W J
R3104	QRL039J-473	OM R	47kΩ 3W J
R3106	NRSA63J-0R0X	MG R	0.0Ω 1/16W J
R3107	NRSA63J-103X	MG R	10kΩ 1/16W J
R3108	QRC121K-561Z	COMP.R	560 Ω 1/2W K
R3110	NRSA63J-0R0X	MG R	0.0Ω 1/16W J
CAPACITOR			
C3006	QFZ9027-472	MM CAP.	4700pF AC125V K
C3007	QETN2EM-106Z	E CAP.	10μF 250V M
C3101	QETN1HM-106Z	E CAP.	10μF 50V M
C3102	NCB31HK-103X	C CAP.	0.01μF 50V K
C3103	QETN1EM-476Z	E CAP.	47μF 25V M
C3106	QFK62EK-104Z	MM CAP.	0.1μF 250V K
C3107	NDC31HJ-561X	C CAP.	560pF 50V J
C3108	NDC31HJ-100X	C CAP.	10pF 50V J
COIL			
L3002	QQL26AJ-102Z	COIL	1mH J
L3101	QQL244K-5R6Z	COIL	5.6μH K
L3102	QQL244K-4R7Z	COIL	4.7μH K
DIODE			
D3001	RM2C-LFA1	SI.DIODE	
D3101	EU01N-T2	SI.DIODE	
D3102	1SR124-400A-T2	SI.DIODE	
IC			
IC3101	TDA6111Q	I.C. (MONO-ANA)	
OTHERS			
△ SG3001	CE42447-501	ARRESTOR	
△ SK3001	CE42535-001J1	C.R.T. SOCKET	

G CRT SOCKET P.W. BOARD ASS'Y (SSB-3251A-M2)

△ Symbol No.	Part No.	Part Name	Description
RESISTOR			
R3001	NRVA63D-123X	MF R	12kΩ 1/16W±0.5%
R3002	NRVA63D-223X	CHIP MF R	22kΩ 1/16W±0.5%
R3003	NRVA63D-472X	MF R	4.7kΩ 1/16W±0.5%
R3005	QRE121J-105Y	C R	1MΩ 1/2W J
R3006	QRC121K-102Z	COMP.R	1kΩ 1/2W K
R3008	QRC121K-152Z	COMP.R	1.5kΩ 1/2W K
R3013-14	NRSA63J-0R0X	MG R	0.0Ω 1/16W J
R3101	NRSA63J-681X	MG R	680Ω 1/16W J
R3103	NRSA63J-821X	MG R	820Ω 1/16W J
R3104	QRL039J-473	OM R	47kΩ 3W J
R3106	NRSA63J-0R0X	MG R	0.0Ω 1/16W J
R3107	NRSA63J-103X	MG R	10kΩ 1/16W J
R3108	QRC121K-561Z	COMP.R	560 Ω 1/2W K
R3110	NRSA63J-0R0X	MG R	0.0Ω 1/16W J
CAPACITOR			
△ C3001	QETM2EM-336	E CAP.	33μF 250V M
C3002	QETN2EM-106Z	E CAP.	10μF 250V M
C3003	QFLC1HJ-223Z	M CAP.	0.022μF 50V J
C3006	QFZ9027-472	MM CAP.	4700pF AC125V K
C3007	QETN2EM-106Z	E CAP.	10μF 250V M
C3101	QETN1HM-106Z	E CAP.	10μF 50V M
C3102	NCB31HK-103X	C CAP.	0.01μF 50V K
C3103	QETN1EM-476Z	E CAP.	47μF 25V M
C3106	QFK62EK-104Z	MM CAP.	0.1μF 250V K
C3107	NDC31HJ-561X	C CAP.	560pF 50V J
C3108	NDC31HJ-100X	C CAP.	10pF 50V J
COIL			
L3001-02	QQL26AJ-102Z	COIL	1mH J
L3101	QQL244K-5R6Z	COIL	5.6μH K
L3102	QQL244K-4R7Z	COIL	4.7μH K
DIODE			
D3001	RM2C-LFA1	SI.DIODE	
D3101	EU01N-T2	SI.DIODE	
D3102	1SR124-400A-T2	SI.DIODE	
IC			
IC3101	TDA6111Q	I.C. (MONO-ANA)	
OTHERS			
△ FR3007	QRZ9009-1R5	F R	1.5 Ω 1/2W J
△ SG3001	CE42447-501	ARRESTOR	
△ SK3001	CE42535-001J1	C.R.T. SOCKET	

B CRT SOCKET P.W. BOARD ASS'Y
(SSB-3351A-M2)

△ Symbol No.	Part No.	Part Name	Description
RESISTOR			
R3005	QRE121J-105Y	C R	1MΩ 1/2W J
R3006	QRC121K-102Z	COMP.R	1kΩ 1/2W K
R3008	QRC121K-152Z	COMP.R	1.5kΩ 1/2W K
R3031	NRVA63D-123X	MF R	12kΩ 1/16W±0.5%
R3032	NRVA63D-562X	MF R	5.6kΩ 1/16W±0.5%
R3033	NRVA63D-333X	CHIP MF R	33kΩ 1/16W±0.5%
R3101	NRSA63J-681X	MG R	680Ω 1/16W J
R3103	NRSA63J-821X	MG R	820Ω 1/16W J
R3104	QRL039J-473	OM R	47kΩ 3W J
R3105	NRSA63J-681X	MG R	680Ω 1/16W J
R3106	NRSA63J-0R0X	MG R	0.0Ω 1/16W J
R3107	NRSA63J-103X	MG R	10kΩ 1/16W J
R3108	QRC121K-561Z	COMP.R	560 Ω 1/2W K
R3110	NRSA63J-0R0X	MG R	0.0Ω 1/16W J
CAPACITOR			
C3006	QFZ9027-472	MM CAP.	4700pF AC125V K
C3007	QETN2EM-106Z	E CAP.	10μF 250V M
C3101	QETN1HM-106Z	E CAP.	10μF 50V M
C3102	NCB31HK-103X	C CAP.	0.01μF 50V K
C3103	QETN1EM-476Z	E CAP.	47μF 25V M
C3106	QFK62EK-104Z	MM CAP.	0.1μF 250V K
C3107	NDC31HJ-561X	C CAP.	560pF 50V J
C3108	NDC31HJ-100X	C CAP.	10pF 50V J
COIL			
L3002	QQL26AJ-102Z	COIL	1mH J
L3101	QQL244K-5R6Z	COIL	5.6μH K
L3102	QQL244K-4R7Z	COIL	4.7μH K
DIODE			
D3001	RM2C-LFA1	SI DIODE	
D3101	EU01N-T2	SI DIODE	
D3102	1SR124-400A-T2	SI DIODE	
D3103	MA111-X	SI DIODE	
TRANSISTOR			
Q3031	2SA1037AK/QR/-X	SI TRANSISTOR	
IC			
IC3101	TDA6111Q	I.C. (MONO-ANA)	
OTHERS			
△ SG3001	CE42447-501	ARRESTOR	
SK3001	CE42535-001J1	C.R.T. SOCKET	

CONVERGENCE P.W. BOARD ASS'Y
(SSB-5051A-M2)

△ Symbol No.	Part No.	Part Name	Description
RESISTOR			
R5801-08	NRSA63J-272X	MG R	2.7kΩ 1/16W J
R5809	QRE121J-471Y	C R	470Ω 1/2W J
R5810	NRSA63J-122X	MG R	1.2kΩ 1/16W J
R5812-13	NRSA63J-102X	MG R	1kΩ 1/16W J
R5814	NRSA63J-333X	MG R	33kΩ 1/16W J
R5815	NRSA63J-473X	MG R	47kΩ 1/16W J
R5818	NRSA63J-101X	MG R	100Ω 1/16W J
R5826	NRSA63J-473X	MG R	47kΩ 1/16W J
R5827	NRSA63J-103X	MG R	10kΩ 1/16W J
R5828-30	NRSA63J-101X	MG R	100Ω 1/16W J

△ Symbol No.	Part No.	Part Name	Description
RESISTOR			
R5831-33	NRSA63J-102X	MG R	1kΩ 1/16W J
R5834-39	NRSA63J-473X	MG R	47kΩ 1/16W J
R5840	NRSA63J-332X	MG R	3.3kΩ 1/16W J
R5842	QRX01GJ-2R2	MF R	2.2Ω 1W J
R5843	QRL029J-221	OM R	220Ω 2W J
R5844	NRSA63J-332X	MG R	3.3kΩ 1/16W J
R5846	QRX01GJ-1R5	MF R	1.5Ω 1W J
R5847	QRL029J-151	OM R	150Ω 2W J
R5848	NRSA63J-332X	MG R	3.3kΩ 1/16W J
R5850	QRX01GJ-2R2	MF R	2.2Ω 1W J
R5851	QRL029J-221	OM R	220Ω 2W J
R5852	NRSA63J-332X	MG R	3.3kΩ 1/16W J
R5854	QRX01GJ-1R5	MF R	1.5Ω 1W J
R5855	QRL029J-151	OM R	150Ω 2W J
R5856	NRSA63J-332X	MG R	3.3kΩ 1/16W J
R5858	QRX01GJ-3R3	MF R	3.3Ω 1W J
R5859	QRL029J-221	OM R	220Ω 2W J
R5860	NRSA63J-332X	MG R	3.3kΩ 1/16W J
R5862	QRX01GJ-1R8	MF R	1.8Ω 1W J
R5863	QRL029J-151	OM R	150Ω 2W J
R5864	NRSA63J-101X	MG R	100Ω 1/16W J
R5893	NRSA63J-0R0X	MG R	0.0Ω 1/16W J
CAPACITOR			
C5801-03	QETN1CM-107Z	E CAP.	100μF 16V M
C5804	NCB31EK-104X	C CAP.	0.1μF 25V K
C5805	QETN1CM-107Z	E CAP.	100μF 16V M
C5806	NCB31EK-104X	C CAP.	0.1μF 25V K
C5807	QETN1CM-107Z	E CAP.	100μF 16V M
C5808-09	NCB31EK-104X	C CAP.	0.1μF 25V K
C5810	QETN1EM-107Z	E CAP.	100μF 25V M
C5813-14	NCB31EK-104X	C CAP.	0.1μF 25V K
C5815	NCB31HK-102X	C CAP.	1000pF 50V K
C5818-19	NCB31HK-103X	C CAP.	0.01μF 50V K
C5820-25	NDC31HJ-151X	C CAP.	150pF 50V J
C5827-28	QETN1HM-477Z	E CAP.	470μF 50V M
C5829-34	NDC31HJ-151X	C CAP.	150pF 50V J
C5838	NCB31EK-104X	C CAP.	0.1μF 25V K
C5843	NCB31HK-103X	C CAP.	0.01μF 50V K
DIODE			
D5801	RK14-T3	SI DIODE	
D5804-05	1SR153-400-T2	SI DIODE	
D5816-27	RD33E/B2/-T2	ZENER DIODE	
D5839	NRSA63J-0R0X	MG R	0.0Ω 1/16W J
D5841-43	PTZ6.8B-X	ZENER DIODE	
TRANSISTOR			
Q5801	2SC3852A	SI TRANSISTOR	
Q5802-03	2SA673/C/-T	SI TRANSISTOR	
Q5806-08	2SD601A/QR/-X	SI TRANSISTOR	
Q5811	2SD601A/QR/-X	SI TRANSISTOR	
IC			
IC5801	BA17805T	I.C. (MONO-ANA)	
IC5803	BA17805T	I.C. (MONO-ANA)	
IC5804-05	STK392-110	I.C. (HYBRID)	
OTHERS			
K5801	QQR0621-002Z	BEADS CORE	
K5802	QQR0621-002Z	BEADS CORE	
K5803	QQR0621-002Z	BEADS CORE	
K5804	QQR0621-002Z	BEADS CORE	
K5805	QQR0621-002Z	BEADS CORE	
K5806	QQR0621-002Z	BEADS CORE	
K5807	QQR0621-002Z	BEADS CORE	
K5808	QQR0621-002Z	BEADS CORE	
K5809	QQR0621-002Z	BEADS CORE	
K5810	QQR0621-002Z	BEADS CORE	
K5811	QQR0621-002Z	BEADS CORE	
MD5001	QAL0382-001	CONVER MODULE	
S5801	QSW0619-003Z	PUSH SWITCH	SERVICE SW

R VM P.W. BOARD ASS'Y (SSB-7151A-M2)

△ Symbol No.	Part No.	Part Name	Description
RESISTOR			
R7101	NRSA63J-101X	MG R	100Ω 1/16W J
R7102	NRSA63J-223X	MG R	22kΩ 1/16W J
R7103-04	NRSA63J-332X	MG R	3.3kΩ 1/16W J
R7105	NRSA63J-391X	MG R	390Ω 1/16W J
R7106	NRSA63J-471X	MG R	470Ω 1/16W J
R7107	NRSA63J-392X	MG R	3.9kΩ 1/16W J
△ R7110	QRJ146J-182X	C R	1.8kΩ 1/4W J
R7111-12	NRSA63J-104X	MG R	100kΩ 1/16W J
△ R7113	QRJ146J-182X	C R	1.8kΩ 1/4W J
△ R7114	QRJ146J-470X	C R	47Ω 1/4W J
△ R7115	QRJ146J-470X	C R	47Ω 1/4W J
R7116	QRG01GJ-150	OM R	15Ω 1W J
R7117-18	NRSA63J-104X	MG R	100kΩ 1/16W J
R7119	QRG01GJ-180	OM R	18Ω 1W J
R7120-22	QRL039J-330	OM R	33Ω 3W J
R7124	NRSA63J-101X	MG R	100Ω 1/16W J
CAPACITOR			
C7101	NCB31HK-102X	C CAP.	1000pF 50V K
C7102	QETN1HM-106Z	E CAP.	10μF 50V M
C7103	NCF21HZ-104X	C CAP.	0.1μF 50V Z
C7104	NCB31HK-472X	C CAP.	4700pF 50V K
C7107-08	QFN32DK-103	M CAP.	0.01μF 200V K
C7109	QETN2CM-106Z	E CAP.	10μF 160V M
C7110-11	QETN2CM-226Z	E CAP.	22μF 160V M
C7112-13	QFN31HJ-222Z	M CAP.	2200pF 50V J
C7116	QCS32HJ-330Z	C CAP.	33pF 500V J
C7117-18	QFN32DK-103	M CAP.	0.01μF 200V K
C7119	QCB32HK-103	C CAP.	0.01μF 500V K
C7120	QCB32HK-102Z	C CAP.	1000pF 500V K
DIODE			
D7101	1SS355-X	SI.DIODE	
D7102	RH1S-T3	SI.DIODE	
D7103	RH1S-T3	SI.DIODE	
TRANSISTOR			
Q7101	2SC1906-T	SI.TRANSISTOR	
Q7102	2SA1005/MLK/-T	SI.TRANSISTOR	
Q7103	2SC1959/Y/-T	SI.TRANSISTOR	
Q7104	2SA562TM/Y/-T	SI.TRANSISTOR	
Q7105	2SJ403	F.E.T.	
Q7106	IRF1620G	F.E.T.	
OTHERS			
K7101	CE41492-001Z	CHOKE COIL	

G VM P.W. BOARD ASS'Y (SSB-7251A-M2)

△ Symbol No.	Part No.	Part Name	Description
RESISTOR			
R7101	NRSA63J-101X	MG R	100Ω 1/16W J
R7102	NRSA63J-223X	MG R	22kΩ 1/16W J
R7103-04	NRSA63J-332X	MG R	3.3kΩ 1/16W J
R7105	NRSA63J-391X	MG R	390Ω 1/16W J
R7106	NRSA63J-471X	MG R	470Ω 1/16W J
R7107	NRSA63J-392X	MG R	3.9kΩ 1/16W J
△ R7110	QRJ146J-182X	C R	1.8kΩ 1/4W J
R7111-12	NRSA63J-104X	MG R	100kΩ 1/16W J
△ R7113	QRJ146J-182X	C R	1.8kΩ 1/4W J
△ R7114	QRJ146J-470X	C R	47Ω 1/4W J
△ R7115	QRJ146J-470X	C R	47Ω 1/4W J
R7116	QRG01GJ-150	OM R	15Ω 1W J
R7117-18	NRSA63J-104X	MG R	100kΩ 1/16W J
R7119	QRG01GJ-180	OM R	18Ω 1W J
R7120-22	QRL039J-330	OM R	33Ω 3W J
R7124	NRSA63J-101X	MG R	100Ω 1/16W J
CAPACITOR			
C7101	NCB31HK-102X	C CAP.	1000pF 50V K
C7102	QETN1HM-106Z	E CAP.	10μF 50V M
C7103	NCF21HZ-104X	C CAP.	0.1μF 50V Z
C7104	NCB31HK-472X	C CAP.	4700pF 50V K
C7107-08	QFN32DK-103	M CAP.	0.01μF 200V K
C7109	QETN2CM-106Z	E CAP.	10μF 160V M
C7110-11	QETN2CM-226Z	E CAP.	22μF 160V M
C7112-13	QFN31HJ-222Z	M CAP.	2200pF 50V J
C7116	QCS32HJ-330Z	C CAP.	33pF 500V J
C7117-18	QFN32DK-103	M CAP.	0.01μF 200V K
C7119	QCB32HK-103	C CAP.	0.01μF 500V K
C7120	QCB32HK-102Z	C CAP.	1000pF 500V K
DIODE			
D7101	1SS355-X	SI.DIODE	
D7102	RH1S-T3	SI.DIODE	
D7103	RH1S-T3	SI.DIODE	
TRANSISTOR			
Q7101	2SC1906-T	SI.TRANSISTOR	
Q7102	2SA1005/MLK/-T	SI.TRANSISTOR	
Q7103	2SC1959/Y/-T	SI.TRANSISTOR	
Q7104	2SA562TM/Y/-T	SI.TRANSISTOR	
Q7105	2SJ403	F.E.T.	
Q7106	IRF1620G	F.E.T.	
OTHERS			
K7101	CE41492-001Z	CHOKE COIL	

B VM P.W. BOARD ASS'Y (SSB-7351A-M2)

△ Symbol No.	Part No.	Part Name	Description
RESISTOR			
R7101	NRSA63J-101X	MG R	100Ω 1/16W J
R7102	NRSA63J-223X	MG R	22kΩ 1/16W J
R7103-04	NRSA63J-332X	MG R	3.3kΩ 1/16W J
R7105	NRSA63J-391X	MG R	390Ω 1/16W J
R7106	NRSA63J-471X	MG R	470Ω 1/16W J
R7107	NRSA63J-392X	MG R	3.9kΩ 1/16W J
△ R7110	QRJ146J-182X	C R	1.8kΩ 1/4W J
R7111-12	NRSA63J-104X	MG R	100kΩ 1/16W J
△ R7113	QRJ146J-182X	C R	1.8kΩ 1/4W J
R7114	QRJ146J-470X	C R	47Ω 1/4W J
△ R7115	QRJ146J-470X	C R	47Ω 1/4W J
R7116	QRG01GJ-150	OM R	15Ω 1W J
R7117-18	NRSA63J-104X	MG R	100kΩ 1/16W J
R7119	QRG01GJ-180	OM R	18Ω 1W J
R7120-22	QRL039J-330	OM R	33Ω 3W J
R7124	NRSA63J-101X	MG R	100Ω 1/16W J
CAPACITOR			
C7101	NCB31HK-102X	C CAP.	1000pF 50V K
C7102	QETN1HM-106Z	E CAP.	10μF 50V M
C7103	NCF21HZ-104X	C CAP.	0.1μF 50V Z
C7104	NCB31HK-472X	C CAP.	4700pF 50V K
C7107-08	QFN32DK-103	M CAP.	0.01μF 200V K
C7109	QETN2CM-106Z	E CAP.	10μF 160V M
C7110-11	QETN2CM-226Z	E CAP.	22μF 160V M
C7112-13	QFN31HJ-222Z	M CAP.	2200pF 50V J
C7116	QCS32HJ-330Z	C CAP.	33pF 500V J
C7117-18	QFN32DK-103	M CAP.	0.01μF 200V K
C7119	QCB32HK-103	C CAP.	0.01μF 500V K
C7120	QCB32HK-102Z	C CAP.	1000pF 500V K
DIODE			
D7101	1SS355-X	SI.DIODE	
D7102	RH1S-T3	SI.DIODE	
D7103	RH1S-T3	SI.DIODE	
TRANSISTOR			
Q7101	2SC1906-T	SI.TRANSISTOR	
Q7102	2SA1005/MLK/-T	SI.TRANSISTOR	
Q7103	2SC1959/Y/-T	SI.TRANSISTOR	
Q7104	2SA562TM/Y/-T	SI.TRANSISTOR	
Q7105	2SJ403	F.E.T.	
Q7106	IRFI620G	F.E.T.	
OTHERS			
K7101	CE41492-001Z	CHOKE COIL	

CENTER SPEAKER P.W. BOARD ASS'Y
(SSB0A051A-M2)

△ Symbol No.	Part No.	Part Name	Description
OTHERS			
J0001	CEMT019-001	SPK TERMINAL	

LINE FILTER P.W. BOARD ASS'Y (SSB-9051A-M2)

△ Symbol No.	Part No.	Part Name	Description
RESISTOR			
△ R9901	QRZ9041-275	C R	2.7MΩ 1/2W K
R9911	QRE121J-5R6Y	C R	5.6Ω 1/2W J
CAPACITOR			
△ C9901	QFZ9072-104	M F CAP.	0.1μFAC275V K
△ C9902	QFZ9072-104	M F CAP.	0.1μFAC275V K
△ C9903	QFZ9072-104	M F CAP.	0.1μFAC275V K
C9911	QETN1CM-108Z	E CAP.	1000μF 16V M
C9921	QETM1HM-108	E CAP.	1000μF 50V M
TRANSFORMER			
△ T9911	QQT0361-001	POWER TRANSF.	
DIODE			
D9911-14	1SR35-400A-T2	SI.DIODE	
D9921	1SR35-400A-T2	SI.DIODE	
OTHERS			
△	QMPD200-200-JC	POWER CORD	
	A49593	CONNECTOR CLIP	
△ F9901	QMF61U1-7R0-S	FUSE	7.0A
△ LF9901	QQR0972-002	LINE FILTER	
△ LF9902	QQR0972-002	LINE FILTER	
△ LF9903	QQR1281-001	LINE FILTER	
△ VA9901	ERZV10V621CS	VARISTOR	

REMOCON SENSOR P.W. BOARD ASS'Y
(SSB-8051A-M2)

△ Symbol No.	Part No.	Part Name	Description
RESISTOR			
R8001	NRSA63J-102X	MG R	1kΩ 1/16W J
CAPACITOR			
C8001	NCB31CK-104X	C CAP.	0.1μF 16V K
C8002	QETN1EM-476Z	E CAP.	47μF 25V M
DIODE			
D8001	MA3068/M/-X	ZENER DIODE	
IC			
IC8001	GPIU281Q	IFR DETECT UNIT	

DEF. OSC. P.W. BOARD ASS'Y (SSB0H051A-M2)

△ Symbol No.	Part No.	Part Name	Description
--------------	----------	-----------	-------------

RESISTOR

R0101	NRSA63J-102X	MG R	1kΩ 1/16W J
R0103	NRSA63J-681X	MG R	680Ω 1/16W J
R0104	NRSA63J-103X	MG R	10kΩ 1/16W J
R0105	NRSA63J-473X	MG R	47kΩ 1/16W J
R0106	NRSA63J-123X	MG R	12kΩ 1/16W J
R0107	NRSA63J-103X	MG R	10kΩ 1/16W J
R0109	NRSA63J-682X	MG R	6.8kΩ 1/16W J
R0110	NRSA63J-223X	MG R	22kΩ 1/16W J
R0111	NRVA63D-153X	MF R	15kΩ 1/16W±0.5%
R0112	NRVA63D-182X	MF R	1.8kΩ 1/16W±0.5%
R0113	NRVA63D-123X	MF R	12kΩ 1/16W±0.5%
R0114	NRSA63J-222X	MG R	2.2kΩ 1/16W J
R0116	NRVA63D-182X	MF R	1.8kΩ 1/16W±0.5%
R0117	NRSA63J-332X	MG R	3.3kΩ 1/16W J
R0120	NRSA63J-183X	MG R	18kΩ 1/16W J
R0121	NRSA63J-152X	MG R	1.5kΩ 1/16W J
R0122	QRG01GJ-470	OM R	47Ω 1W J
△ R0123	QRK126J-101X	C R	100Ω 1/2W J
R0126-27	NRSA63J-472X	MG R	4.7kΩ 1/16W J
R0129	NRVA63D-183X	MF R	18kΩ 1/16W±0.5%
R0131	NRSA63J-102X	MG R	1kΩ 1/16W J
R0133	NRSA63J-151X	MG R	150Ω 1/16W J
R0134	NRSA63J-334X	MG R	330kΩ 1/16W J
R0137	NRSA63J-103X	MG R	10kΩ 1/16W J
R0139	NRSA63J-223X	MG R	22kΩ 1/16W J
R0140	NRSA63J-103X	MG R	10kΩ 1/16W J
R0141	NRSA63J-472X	MG R	4.7kΩ 1/16W J
R0142	NRSA63J-103X	MG R	10kΩ 1/16W J
R0143	NRSA63J-471X	MG R	470Ω 1/16W J
R0161-62	NRSA63J-221X	MG R	220Ω 1/16W J
R0163-64	NRSA63J-101X	MG R	100Ω 1/16W J
R0167-68	NRSA63J-472X	MG R	4.7kΩ 1/16W J
R0169	NRSA63J-332X	MG R	3.3kΩ 1/16W J
R0170	NRSA63J-472X	MG R	4.7kΩ 1/16W J
R0171	NRSA63J-223X	MG R	22kΩ 1/16W J
R0172	NRSA63J-473X	MG R	47kΩ 1/16W J
R0174-75	NRSA63J-102X	MG R	1kΩ 1/16W J
R0176	NRSA63J-222X	MG R	2.2kΩ 1/16W J
R0177	NRSA63J-123X	MG R	12kΩ 1/16W J
R0178	NRSA63J-821X	MG R	820Ω 1/16W J
R0179	NRVA63D-562X	MF R	5.6kΩ 1/16W±0.5%
R0180	NRVA63D-152X	MF R	1.5kΩ 1/16W±0.5%
R0182-83	NRSA63J-102X	MG R	1kΩ 1/16W J
R0184	NRVA63D-473X	MF R	47kΩ 1/16W±0.5%
R0185	NRVA63D-103X	MF R	10kΩ 1/16W±0.5%
R0186	NRSA63J-103X	MG R	10kΩ 1/16W J
R0187	NRSA63J-472X	MG R	4.7kΩ 1/16W J
R0188	NRVA63D-101X	MF R	100Ω 1/16W±0.5%
R0189	NRSA63J-0R0X	MG R	0.0Ω 1/16W J
R0190	NRSA63J-181X	MG R	180Ω 1/16W J
R0216-17	NRSA63J-221X	MG R	220Ω 1/16W J
R0223-24	NRSA63J-101X	MG R	100Ω 1/16W J
R0226	NRSA63J-101X	MG R	100Ω 1/16W J
R0227	NRSA63J-102X	MG R	1kΩ 1/16W J
R0230	NRSA63J-223X	MG R	22kΩ 1/16W J
R0321	NRSA63J-0R0X	MG R	0.0Ω 1/16W J

R0326-27	NRSA63J-224X	MG R	220kΩ 1/16W J
R0328	NRSA63J-563X	MG R	56kΩ 1/16W J
R0329	NRSA63J-224X	MG R	220kΩ 1/16W J
R0330	NRSA63J-683X	MG R	68kΩ 1/16W J
R0751	NRSA63J-183X	MG R	18kΩ 1/16W J
R0752	NRSA63J-103X	MG R	10kΩ 1/16W J
R0753	NRSA63J-822X	MG R	8.2kΩ 1/16W J
R0754-55	NRSA63J-183X	MG R	18kΩ 1/16W J

△ Symbol No.	Part No.	Part Name	Description
--------------	----------	-----------	-------------

RESISTOR

R0756	NRSA63J-392X	MG R	3.9kΩ 1/16W J
R0757	NRSA63J-152X	MG R	1.5kΩ 1/16W J
R0761-65	QRE121J-184Y	C R	180kΩ 1/2W J

CAPACITOR

C0102-03	NCB31HK-103X	C CAP.	0.01μF 50V K
C0104	NDC31HJ-561X	C CAP.	560pF 50V J
C0106	NDC31HJ-102X	C CAP.	1000pF 50V J
C0107	NDC21HJ-122X	C CAP.	1200pF 50V J
C0108	QETN1HM-475Z	E CAP.	4.7μF 50V M
C0109	NCB31HK-103X	C CAP.	0.01μF 50V K
C0110	NCB31HK-102X	C CAP.	1000pF 50V K
C0111-12	QETN1HM-225Z	E CAP.	2.2μF 50V M
C0113	NDC21HJ-122X	C CAP.	1200pF 50V J
C0114-15	NDC31HJ-102X	C CAP.	1000pF 50V J
C0116	NCB31HK-103X	C CAP.	0.01μF 50V K
C0117	QTMN1CM-477Z	E CAP.	470μF 16V M
C0118	NCB31HK-103X	C CAP.	0.01μF 50V K
C0119-20	QETN1EM-476Z	E CAP.	47μF 25V M
C0121	QETN1CM-107Z	E CAP.	100μF 16V M
C0122-24	NCB31HK-103X	C CAP.	0.01μF 50V K
C0131	NDC31HJ-101X	C CAP.	100pF 50V J
C0132	QETN1HM-105Z	E CAP.	1.0μF 50V M
C0133	NCB31CK-104X	C CAP.	0.1μF 16V K
C0134	NCB31EK-273X	CHIP CAP.	0.027μF 25V K
C0135-37	NDC31HJ-102X	C CAP.	1000pF 50V J
C0138	NDC31HJ-151X	C CAP.	150pF 50V J
C0161	QETN1CM-108Z	E CAP.	1000μF 16V M
C0162	NCB31HK-103X	C CAP.	0.01μF 50V K
C0163	QETN1AM-477Z	E CAP.	470μF 10V M
C0164	NCB31HK-103X	C CAP.	0.01μF 50V K
C0165	NCB31CK-104X	C CAP.	0.1μF 16V K
C0166	QETN1HM-106Z	E CAP.	10μF 50V M
C0167	NCB31HK-332X	C CAP.	3300pF 50V K
C0168	NCB31HK-103X	C CAP.	0.01μF 50V K
C0169	NCB31CK-104X	C CAP.	0.1μF 16V K
C0170	NCB31HK-103X	C CAP.	0.01μF 50V K
C0171	QFV71HJ-184Z	MF CAP.	0.18μF 50V J
C0172	QFV71HJ-394Z	MF CAP.	0.39μF 50V J
C0173	NCB31HK-153X	C CAP.	0.015μF 50V K
C0174	NCB31HK-272X	CHIP CAP.	2700pF 50V K
C0175	NCB31HK-152X	C CAP.	1500pF 50V K
C0176	QFV71HJ-104Z	MF CAP.	0.1μF 50V J
C0178-82	NCB31CK-104X	C CAP.	0.1μF 16V K
C0212	QETN1HM-106Z	E CAP.	10μF 50V M
C0221	QETN1HM-105Z	E CAP.	1.0μF 50V M
C0321	NCB31HK-102X	C CAP.	1000pF 50V K
C0751	QFLC1HJ-563Z	M CAP.	0.056μF 50V J
C0752	QETN1VM-476Z	E CAP.	47μF 35V M
△ C0753	QFZ0200-153	MPP CAP.	0.015μF1.5kVH±3%
△ C0761	QFZ0122-682	MPP CAP.	6800pF1.8kVH±3%
C0762-63	QCZ0122-471	C CAP.	470pF 2kV K

COIL

L0101	QQL01BK-470Z	COIL	47μH K
L0103-04	NQL092K-100X	COIL	10μH
L0105	QQL01BK-101Z	COIL	100μH K

DIODE

D0164-65	1S5355-X	SI.DIODE	
D0221	1S5355-X	SI.DIODE	
D0321	1S5355-X	SI.DIODE	
D0751-52	ES1F-LFG2	SI.DIODE	

△ Symbol No.	Part No.	Part Name	Description
TRANSISTOR			
Q0101-02	2SD601A/QR/-X	SI. TRANSISTOR	
Q0131-32	2SD601A/QR/-X	SI. TRANSISTOR	
Q0162	2SD601A/QR/-X	SI. TRANSISTOR	
Q0167-68	2SD601A/QR/-X	SI. TRANSISTOR	
Q0751-52	2SD601A/QR/-X	SI. TRANSISTOR	
Q0753	2SC4632	SI. TRANSISTOR	
IC			
IC0101	LA7860M-X	I.C. (MONO-ANA)	
IC0102	BA12FP-X	I.C. (MONO-ANA)	
IC0161	AN5441SA-W	I.C. (MONO-ANA)	
IC0162	BA10393F-XE	I.C. (MONO-ANA)	
IC0212	CXA1875AM-X	I.C. (MONO-ANA)	
OTHERS			
CN0010	QGB1505K1-35	PLUG	

AV JACK P.W. BOARD ASS'Y (SSB0J051A-M2)

△ Symbol No.	Part No.	Part Name	Description
RESISTOR			
R0101	NRSA63J-333X	MG R	33kΩ 1/16W J
R0102-04	NRSA63J-750X	MG R	75Ω 1/16W J
R0105-06	NRSA63J-224X	MG R	220kΩ 1/16W J
R0107-08	NRSA63J-0R0X	MG R	0.0Ω 1/16W J
R0125	NRSA63J-750X	MG R	75Ω 1/16W J
R0126-27	NRSA63J-224X	MG R	220kΩ 1/16W J
R0131-33	NRSA63J-0R0X	MG R	0.0Ω 1/16W J
R0141	NRSA63J-333X	MG R	33kΩ 1/16W J
R0142-44	NRSA63J-750X	MG R	75Ω 1/16W J
R0145-46	NRSA63J-224X	MG R	220kΩ 1/16W J
R0147-48	NRSA63J-0R0X	MG R	0.0Ω 1/16W J
R0201-07	NRSA63J-0R0X	MG R	0.0Ω 1/16W J
R0209	NRSA63J-0R0X	MG R	0.0Ω 1/16W J
R0211	NRSA63J-151X	MG R	150Ω 1/16W J
R0213	NRSA63J-151X	MG R	150Ω 1/16W J
R0215-19	NRSA63J-0R0X	MG R	0.0Ω 1/16W J
R0220	NRSA63J-151X	MG R	150Ω 1/16W J
R0322	NRSA63J-750X	MG R	75Ω 1/16W J
R0325	NRSA63J-750X	MG R	75Ω 1/16W J
R0328	NRSA63J-750X	MG R	75Ω 1/16W J
R0342	NRSA63J-750X	MG R	75Ω 1/16W J
R0345	NRSA63J-750X	MG R	75Ω 1/16W J
R0348	NRSA63J-750X	MG R	75Ω 1/16W J
R0401-05	NRSA63J-0R0X	MG R	0.0Ω 1/16W J
R0409-12	NRSA63J-0R0X	MG R	0.0Ω 1/16W J
R0436	NRSA63J-0R0X	MG R	0.0Ω 1/16W J
R0438-41	NRSA63J-0R0X	MG R	0.0Ω 1/16W J
R0471	NRSA02J-221X	MG R	220Ω 1/10W J
R0473	NRSA02J-121X	MG R	120Ω 1/10W J
R0475	NRSA02J-221X	MG R	220Ω 1/10W J
R0477	NRSA02J-121X	MG R	120Ω 1/10W J
R0481-82	NRSA02J-101X	MG R	100Ω 1/10W J
R0601	NRSA02J-0R0X	MG R	0.0Ω 1/10W J
R0602	NRSA02J-103X	MG R	10kΩ 1/10W J
R0603	NRSA02J-473X	MG R	47kΩ 1/10W J
R0604	NRSA02J-393X	MG R	39kΩ 1/10W J
R0605	NRSA02J-104X	MG R	100kΩ 1/10W J
R0607	NRSA02J-333X	MG R	33kΩ 1/10W J

△ Symbol No.	Part No.	Part Name	Description
RESISTOR			
R0608	NRSA02J-103X	MG R	10kΩ 1/10W J
R0609	NRSA02J-0R0X	MG R	0.0Ω 1/10W J
CAPACITOR			
C0101	NCB11CK-105X	C CAP.	1μF 16V K
C0102	NCB31HK-103X	C CAP.	0.01μF 50V K
C0103-04	QETN1HM-106Z	E CAP.	10μF 50V M
C0105-06	QETN1HM-105Z	E CAP.	1.0μF 50V M
C0126	QETN1HM-106Z	E CAP.	10μF 50V M
C0127-28	QETN1HM-105Z	E CAP.	1.0μF 50V M
C0141	NCB11CK-105X	C CAP.	1μF 16V K
C0142	NCB31HK-103X	C CAP.	0.01μF 50V K
C0143-44	QETN1HM-106Z	E CAP.	10μF 50V M
C0145-46	QETN1HM-105Z	E CAP.	1.0μF 50V M
C0321-23	QETN1EH-476Z	E CAP.	47μF 25V M
C0341-43	QETN1HM-105Z	E CAP.	1.0μF 50V M
C0421	NCF11EZ-105X	C CAP.	1μF 25V Z
C0431	NDC21HJ-221X	C CAP.	220pF 50V J
C0432-33	QENC1HM-106Z	BP E CAP.	10μF 50V M
C0434	NDC21HJ-221X	C CAP.	220pF 50V J
C0435-36	QENC1HM-106Z	BP E CAP.	10μF 50V M
C0601	NDC21HJ-680X	C CAP.	68pF 50V J
C0602	QENC1HM-105Z	BP E CAP.	1.0μF 50V M
C0603-04	QETN1EH-476Z	E CAP.	47μF 25V M
C0605	QETN1HM-474Z	E CAP.	0.47μF 50V M
C0606	NCB21HK-222X	C CAP.	2200pF 50V K
C0607	NCB21HK-472X	C CAP.	4700pF 50V K
C0608	NCB21HK-473X	C CAP.	0.047μF 50V K
C0610	QETN1HM-474Z	E CAP.	0.47μF 50V M
C0612	QETN1HM-475Z	E CAP.	4.7μF 50V M
C0613	NDC21HJ-681X	C CAP.	680pF 50V J
C0614	NCB21HK-153X	C CAP.	0.015μF 50V K
C0615	NDC21HJ-102X	C CAP.	1000pF 50V J
C0616	NDC21HJ-821X	C CAP.	820pF 50V J
C0617	NDC21HJ-680X	C CAP.	68pF 50V J
C0618	NDC21HJ-121X	C CAP.	120pF 50V J
C0619-20	NCF11EZ-105X	C CAP.	1μF 25V Z
C0621	NDC21HJ-100X	C CAP.	10pF 50V J
C0622	NDC21HJ-331X	C CAP.	330pF 50V J
COIL			
L0431	QQL25CK-100Z	COIL	10μH K
DIODE			
D0101	UD2S10B-X	ZENER DIODE	
D0141	UD2S10B-X	ZENER DIODE	
D0201-04	UD2S10B-X	ZENER DIODE	
D0207	UD2S10B-X	ZENER DIODE	
D0209-13	UD2S10B-X	ZENER DIODE	
D0215-20	UD2S10B-X	ZENER DIODE	
D0401-06	UD2S9.1B-X	ZENER DIODE	
D0471	MA153A-X	SI. DIODE	
D0473	MA153A-X	SI. DIODE	
IC			
IC0601	M52001SP	I.C. (MONO-ANA)	
OTHERS			
CN0006	QGB1505K1-40	CONNECTOR	
CN0007	QGB1505K1-25	CONNECTOR	
J0101	QNZ0484-006	AV JACK	
J0141	QNZ0484-004	AV JACK	
J0321	QNN0463-001	JACK	
J0341	QNN0463-001	JACK	
LC0321-23	NQR0169-001X	EMI FILTER	
LC0341-43	NQR0169-001X	EMI FILTER	

FRONT CONTROL P.W. BOARD ASS'Y (SSB0L051A-M2)

△ Symbol No.	Part No.	Part Name	Description
RESISTOR			
R0201	NRSA63J-472X	MG R	4.7kΩ 1/16W J
R0202	NRSA63J-0R0X	MG R	0.0Ω 1/16W J
R0203	NRSA63J-822X	MG R	8.2kΩ 1/16W J
R0204	NRSA63J-0R0X	MG R	0.0Ω 1/16W J
R0401	NRSA63J-750X	MG R	75Ω 1/16W J
R0402-03	NRSA63J-224X	MG R	220kΩ 1/16W J
R0404-05	NRSA63J-750X	MG R	75Ω 1/16W J
R0406	NRSA63J-0R0X	MG R	0.0Ω 1/16W J
R0411-20	NRSA63J-0R0X	MG R	0.0Ω 1/16W J
R0702-03	NRSA63J-0R0X	MG R	0.0Ω 1/16W J
R0706	NRSA63J-101X	MG R	100Ω 1/16W J
R0707	NRSA63J-103X	MG R	10kΩ 1/16W J
R0708	NRSA63J-333X	MG R	33kΩ 1/16W J
R0711	NRSA63J-102X	MG R	1kΩ 1/16W J
R0712	NRSA63J-333X	MG R	33kΩ 1/16W J
R0732	NRSA63J-333X	MG R	33kΩ 1/16W J
R0748	NRSA63J-562X	MG R	5.6kΩ 1/16W J
R0749	NRSA63J-153X	MG R	15kΩ 1/16W J
R0750	NRSA63J-562X	MG R	5.6kΩ 1/16W J
R0751	NRSA63J-153X	MG R	15kΩ 1/16W J
CAPACITOR			
C0442-43	QETN1HM-105Z	E CAP.	1.0μF 50V M
C0444-45	QETN1HM-106Z	E CAP.	10μF 50V M
C0446	QFLC1HJ-103Z	M CAP.	0.01μF 50V J
C0711	QETN1CM-336Z	E CAP.	33μF 16V M
C0712-13	NCB31CK-104X	C CAP.	0.1μF 16V K
DIODE			
D0402-06	UDZ510B-X	ZENER DIODE	
D0701	SELU5E20C	L.E.D.	
D0735	UDZ510B-X	ZENER DIODE	
TRANSISTOR			
Q0201	DTC124EKA-X	DIGI. TRANSISTOR	
Q0701-02	2SC2412K/QR/-X	SI. TRANSISTOR	
IC			
IC0201	PC123F2	I.C. (PH. COUPLER)	
IC0702	MM1437AF-X	I.C. (MONO-ANA)	
OTHERS			
J0401	QNZ0438-001	JACK	
S0701	QSW0619-003Z	PUSH SWITCH	POWER
S0702	QSW0619-003Z	PUSH SWITCH	MENU
S0703	QSW0619-003Z	PUSH SWITCH	CH-
S0704	QSW0619-003Z	PUSH SWITCH	CH+
S0705	QSW0619-003Z	PUSH SWITCH	VOL-
S0706	QSW0619-003Z	PUSH SWITCH	VOL+

RECEIVER P.W. BOARD ASS'Y (SSB0R251A-M2)

△ Symbol No.	Part No.	Part Name	Description
RESISTOR			
R0101-02	NRSA63J-103X	MG R	10kΩ 1/16W J
R0103	NRSA63J-333X	MG R	33kΩ 1/16W J
R0104	NRSA63J-103X	MG R	10kΩ 1/16W J
R0105-07	NRSA63J-0R0X	MG R	0.0Ω 1/16W J
R0108	NRSA63J-473X	MG R	47kΩ 1/16W J
R0109-11	NRSA63J-0R0X	MG R	0.0Ω 1/16W J
R0113	NRSA63J-0R0X	MG R	0.0Ω 1/16W J
R0125-26	NRSA63J-0R0X	MG R	0.0Ω 1/16W J
R0201	NRSA63J-102X	MG R	1kΩ 1/16W J
R0202	NRSA63J-682X	MG R	6.8kΩ 1/16W J
R0203	NRSA63J-153X	MG R	15kΩ 1/16W J
R0204	NRSA63J-332X	MG R	3.3kΩ 1/16W J
R0205	NRVA02D-153X	MF R	15kΩ 1/10W D
R0206	NRSA63J-333X	MG R	33kΩ 1/16W J
R0207	NRSA63J-683X	MG R	68kΩ 1/16W J
R0208	NRVA02D-152X	MF R	1.5kΩ 1/10W D
R0209-10	NRSA63J-101X	MG R	100Ω 1/16W J
R0211	NRSA63J-563X	MG R	56kΩ 1/16W J
R0212	NRSA63J-562X	MG R	5.6kΩ 1/16W J
R0213-14	NRSA63J-221X	MG R	220Ω 1/16W J
R0217-18	NRSA63J-0R0X	MG R	0.0Ω 1/16W J
R0531-32	NRSA63J-221X	MG R	220Ω 1/16W J
R0533	NRSA63J-823X	MG R	82kΩ 1/16W J
R0534-35	NRSA63J-221X	MG R	220Ω 1/16W J
R0536	NRSA63J-823X	MG R	82kΩ 1/16W J
R0537-40	NRSA63J-223X	MG R	22kΩ 1/16W J
R0543	NRSA63J-153X	MG R	15kΩ 1/16W J
R0551-52	NRSA63J-224X	MG R	220kΩ 1/16W J
R0631	NRSA63J-102X	MG R	1kΩ 1/16W J
R0632-33	NRSA63J-223X	MG R	22kΩ 1/16W J
R0634	NRSA63J-102X	MG R	1kΩ 1/16W J
R0635-36	NRSA63J-223X	MG R	22kΩ 1/16W J
R0637	NRSA63J-0R0X	MG R	0.0Ω 1/16W J
R0640	NRSA63J-0R0X	MG R	0.0Ω 1/16W J
R0641	NRSA63J-103X	MG R	10kΩ 1/16W J
R0651	NRSA63J-101X	MG R	100Ω 1/16W J
R0653	NRSA63J-101X	MG R	100Ω 1/16W J
R0654	NRSA63J-103X	MG R	10kΩ 1/16W J
R0656-57	NRSA63J-101X	MG R	100Ω 1/16W J
R0658	NRSA63J-103X	MG R	10kΩ 1/16W J
R0659	NRSA63J-104X	MG R	100kΩ 1/16W J
R0660	NRSA63J-103X	MG R	10kΩ 1/16W J
R0661	NRSA63J-472X	MG R	4.7kΩ 1/16W J
R0662	NRSA63J-562X	MG R	5.6kΩ 1/16W J
R0663	NRSA63J-472X	MG R	4.7kΩ 1/16W J
R0664	NRSA63J-562X	MG R	5.6kΩ 1/16W J
R0666-67	NRSA63J-0R0X	MG R	0.0Ω 1/16W J
R0669-70	NRSA63J-0R0X	MG R	0.0Ω 1/16W J
R0701	NRSA63J-102X	MG R	1kΩ 1/16W J
CAPACITOR			
C0102	QETN1CM-477Z	E CAP.	470μF 16V M
C0103-04	QETN1HM-106Z	E CAP.	10μF 50V M
C0201	QETN1HM-105Z	E CAP.	1.0μF 50V M
C0202	NCF31CZ-104X	C CAP.	0.1μF 16V Z
C0203	QETN1CM-107Z	E CAP.	100μF 16V M
C0204	QETN1EM-476Z	E CAP.	47μF 25V M
C0207	QENC1HM-105Z	BP E CAP.	1.0μF 50V M
C0208	NCB31HK-104X	CHIP CAP.	0.1μF 50V K
C0209	QENC1HM-475Z	BP E CAP.	4.7μF 50V M
C0210	NCB31HK-473X	CHIP CAP.	0.047μF 50V K
C0211	QETN1HM-474Z	E CAP.	0.47μF 50V M

△ Symbol No.	Part No.	Part Name	Description
CAPACITOR			
C0212	QETN1HM-225Z	E CAP.	2.2μF 50V M
C0213-14	NCB31HK-104X	CHIP CAP.	0.1μF 50V K
C0215	QBTC1CK-335Z	TAN.CAP.	3.3μF 16V K
C0216	QETN1HM-105Z	E CAP.	1.0μF 50V M
C0217	QBTC1CK-106Z	TAN.CAP.	10μF 16V K
C0218-19	QETN1HM-105Z	E CAP.	1.0μF 50V M
C0220	QETN1HM-475Z	E CAP.	4.7μF 50V M
C0221	QETN1HM-105Z	E CAP.	1.0μF 50V M
C0531-32	QETN1HM-474Z	E CAP.	0.47μF 50V M
C0551-52	QETN1HM-105Z	E CAP.	1.0μF 50V M
C0601-02	QENC1HM-105Z	BP E CAP.	1.0μF 50V M
C0605-06	QETN1HM-225Z	E CAP.	2.2μF 50V M
C0607	NCB31HK-104X	CHIP CAP.	0.1μF 50V K
C0608	NCB31HK-222X	C CAP.	2200pF 50V K
C0609	NCB31HK-104X	CHIP CAP.	0.1μF 50V K
C0610	NCB31HK-222X	C CAP.	2200pF 50V K
C0611	NCB21HK-273X	C CAP.	0.027μF 50V K
C0631-32	QENC1HM-106Z	BP E CAP.	10μF 50V M
C0633	QETN1HM-226Z	E CAP.	22μF 50V M
C0634	QFLC1HJ-153Z	M CAP.	0.015μF 50V J
C0635	QFLC1HJ-473Z	M CAP.	0.047μF 50V J
C0636	QFLC1HJ-153Z	M CAP.	0.015μF 50V J
C0637	QFLC1HJ-473Z	M CAP.	0.047μF 50V J
C0638	QETN1EM-476Z	E CAP.	47μF 25V M
C0639	NCF31CZ-104X	C CAP.	0.1μF 16V Z
C0640	QETN1HM-106Z	E CAP.	10μF 50V M
C0651	NCF31CZ-104X	C CAP.	0.1μF 16V Z
C0652	QETN1EM-476Z	E CAP.	47μF 25V M
C0661-62	QEZO206-335Z	E CAP.	3.3μF 50V M
COIL			
L0101	QRN143J-0R0X	C R	0.0Ω 1/4W J
L0102	QRN143J-0R0X	C R	0.0Ω 1/4W J
DIODE			
D0213-14	UDZ58.2B-X	ZENER DIODE	
D0531-32	UDZ510B-X	ZENER DIODE	
D0533-34	MA111-X	SI DIODE	
D0551-52	UDZ59.1B-X	ZENER DIODE	
D0661	1SS133-T2	SI DIODE	
D0662	1SS133-T2	SI DIODE	
D0701	UDZ58.2B-X	ZENER DIODE	
TRANSISTOR			
Q0101	2SC2412K/QR/-X	SI TRANSISTOR	
Q0531-34	DTC323TK-X	DIGI. TRANSISTOR	
Q0651	2SC2412K/QR/-X	SI TRANSISTOR	
Q0652	2SA1037AK/QR/-X	SI TRANSISTOR	
Q0661-62	2SC3311A/QR/-T	SI TRANSISTOR	
IC			
IC0201	UPC1851BCU	I.C. (MONO-ANA)	
IC0631	NJM2150AD	I.C. (MONO-ANA)	
IC0651	M62320FP-X	I.C. (M)	
OTHERS			
CN0005	QGB1505K1-40	CONNECTOR	
CN0010	QGB1505K1-40	CONNECTOR	
J0531	CEMNO36-004	PIN JACK	
J0701	QNS0001-001	JACK	
RY0661	QSK0133-001	RELAY	
RY0662	QSK0133-001	RELAY	
UD0101	QAU0219-001	RF SPLITTER	
TU0101	QAU0206-001	TUNER	

CONVERGENCE OSD P.W. BOARD ASS'Y
(SSB0T051A-M2)

△ Symbol No.	Part No.	Part Name	Description
RESISTOR			
R0701	NRSA63J-562X	MG R	5.6kΩ 1/16W J
R0702	NRSA63J-471X	MG R	470Ω 1/16W J
R0703	NRSA63J-0R0X	MG R	0.0Ω 1/16W J
R0704	NRSA63J-562X	MG R	5.6kΩ 1/16W J
R0705	NRSA63J-471X	MG R	470Ω 1/16W J
R0706-07	NRSA63J-0R0X	MG R	0.0Ω 1/16W J
R0708	NRSA63J-471X	MG R	470Ω 1/16W J
R0709	NRSA63J-562X	MG R	5.6kΩ 1/16W J
R0713	NRSA63J-0R0X	MG R	0.0Ω 1/16W J
R0714	NRSA63J-473X	MG R	47kΩ 1/16W J
R0715	NRSA63J-102X	MG R	1kΩ 1/16W J
R0716	NRSA63J-473X	MG R	47kΩ 1/16W J
R0717	NRSA63J-102X	MG R	1kΩ 1/16W J
R0718	NRSA63J-0R0X	MG R	0.0Ω 1/16W J
R0721	NRSA63J-183X	MG R	18kΩ 1/16W J
R0722	NRSA63J-333X	MG R	33kΩ 1/16W J
R0731	NRSA63J-683X	MG R	68kΩ 1/16W J
R0732	NRSA63J-0R0X	MG R	0.0Ω 1/16W J
R0733	NRSA63J-683X	MG R	68kΩ 1/16W J
R0735	NRSA63J-102X	MG R	1kΩ 1/16W J
R0736-37	NRSA63J-683X	MG R	68kΩ 1/16W J
R0738	NRSA63J-0R0X	MG R	0.0Ω 1/16W J
R0740	NRSA63J-102X	MG R	1kΩ 1/16W J
R0741-42	NRSA63J-683X	MG R	68kΩ 1/16W J
R0743	NRSA63J-0R0X	MG R	0.0Ω 1/16W J
R0745	NRSA63J-102X	MG R	1kΩ 1/16W J
CAPACITOR			
C0701	QETN1HM-106Z	E CAP.	10μF 50V M
C0702	NCF31CZ-104X	C CAP.	0.1μF 16V Z
C0707-09	NCB11CK-105X	C CAP.	1μF 16V K
C0711	NCF31CZ-104X	C CAP.	0.1μF 16V Z
C0714	NDC31HJ-181X	C CAP.	180pF 50V J
COIL			
L0701	NQL054J-100X	COIL	10μH
TRANSISTOR			
Q0701-05	2SC2412K/QR/-X	SI TRANSISTOR	
IC			
IC0701	TC74HC4053AF-XE	I C	

DIGITAL INPUT MODULE P.W. BOARD ASS'Y
[48WP30CP-S] (SSB-7851A-M2+WJJ024-001A)

△ Symbol No.	Part No.	Part Name	Description
OTHERS			
	48WP30CP-S	DIGITAL INPUT MODULE	

I-P CONVERT MODULE P.W. BOARD ASS'Y
(SSB0D051A-M2)

△ Symbol No.	Part No.	Part Name	Description
OTHER			
	SSB0D051A-M2	I-P CONVERT MODULE	

REMOTE CONTROL UNIT PARTS LIST (RM-C322G-1A)

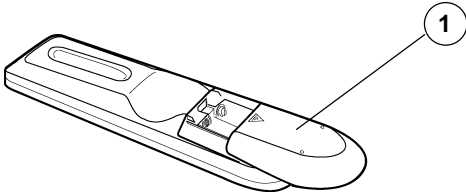

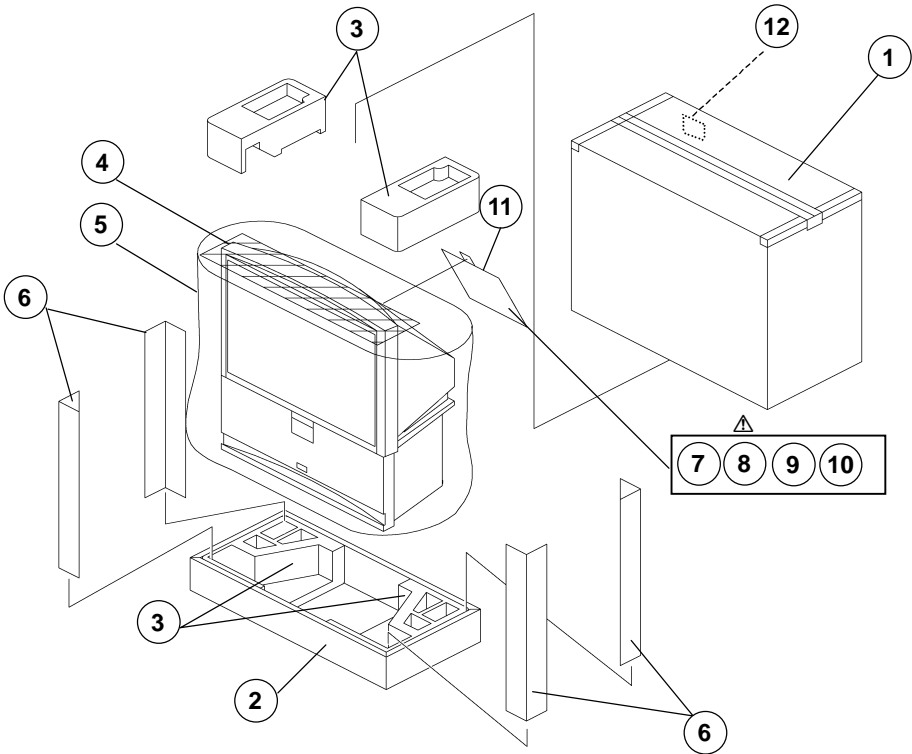

 Ref.No.	Part No.	Part Name	Description
1	UR52EC1286C	BATTERY COVER	

PACKING



PACKING PARTS LIST

 Ref.No.	Part No.	Part Name	Description
1	LC11252-001A	PACKING CASE	
2	LC31759-001A-A	BOTTOM CASE	
3	LC11254-001B	CUSHION ASSY	4pcs in 1set
4	CP30055-007-A	TOP COVER	
5	CP30056-007-A	POLY BAG	
6	LC31361-001A-A	PAD	(x 4)
7	RM-C322G-1A	RC HAND PIECE	
 8	LCT1083-001A-A	INST BOOK	
9	BT-51028-1Q	REGISTRATION C	
10	BT-52004-1Q	WARRANTY CARD	
11	QPA02503505	POLY BAG	
12	CM36616-001-A	CORNER LABEL	